

KACL500 / 600

**Tabelle Schieber
Table of Cam Structure**

Bestellnr. / Catalog No.	W	X ₁	X ₂	Z ₁	Z ₂	Z ₃	Gewicht (kg) / Weight (kg)
KACL 500 / 600-00	500 / 600	323.00	95	385	57.00	110.0	265.6 / 272.4
KACL 500 / 600-05	500 / 600	329.58	80	385	58.64	132.0	262.4 / 269.2
KACL 500 / 600-10	500 / 600	335.94	65	385	62.16	145.0	261.0 / 267.9
KACL 500 / 600-15	500 / 600	341.91	50	385	67.52	170.0	260.2 / 267.1
KACL 500 / 600-20	500 / 600	347.34	35	385	74.69	182.0	260.7 / 267.6
KACL 500 / 600-25	500 / 600	347.06	15	385	83.62	210.0	260.8 / 267.7
KACL 500 / 600-30	500 / 600	350.93	0	385	104.23	179.4	264.4 / 271.3

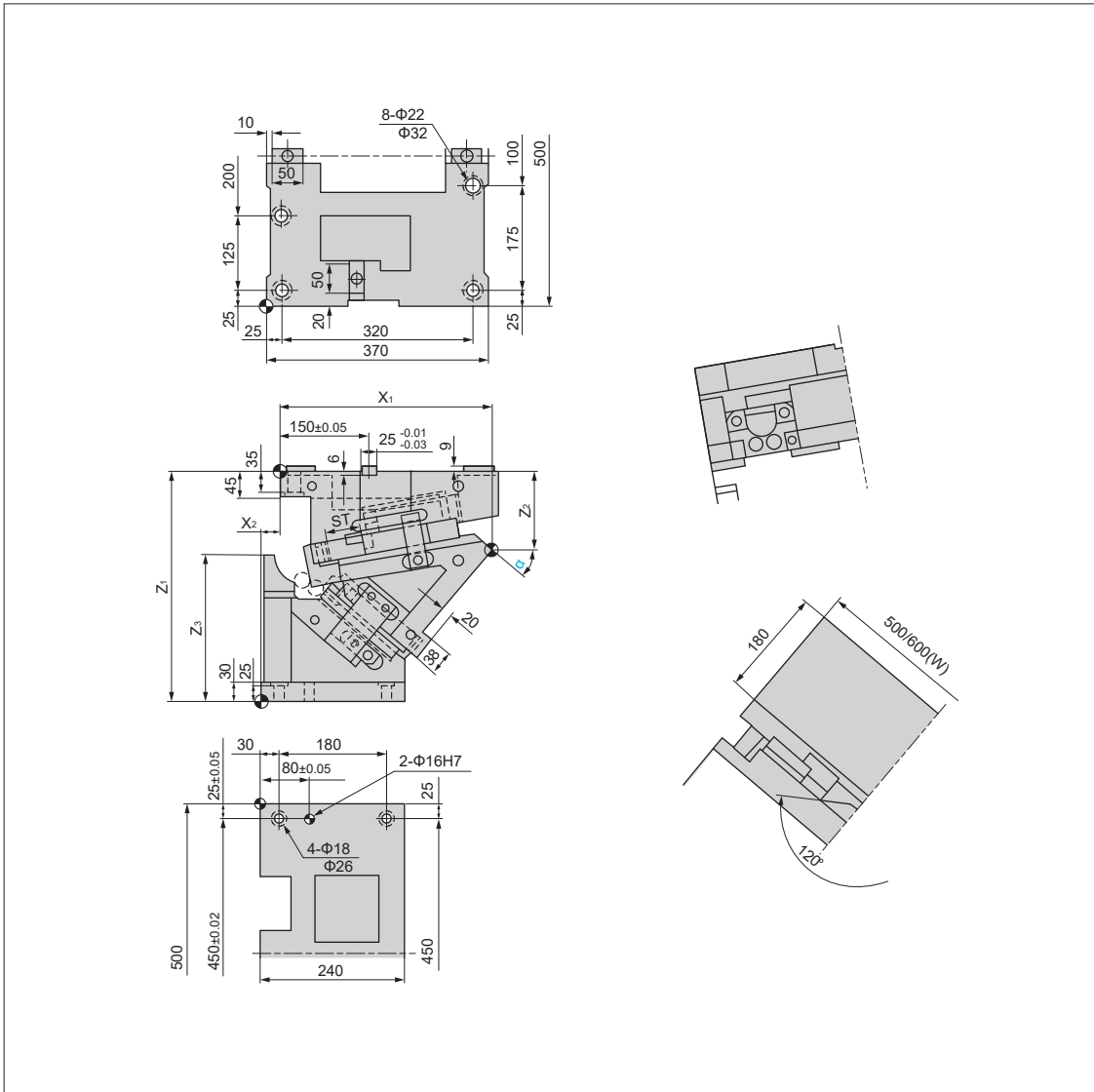

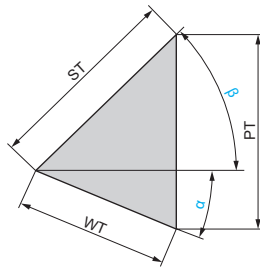

Bestellnr. / Catalog No.	α	β	WT	ST	PT
KACL 500 / 600-00	0	50	38.6	60	46.0
KACL 500 / 600-05	5	45	42.6		46.1
KACL 500 / 600-10	10	40	46.7		46.7
KACL 500 / 600-15	15	35	50.9		47.6
KACL 500 / 600-20	20	30	55.3		48.9
KACL 500 / 600-25	25	25	60.0		50.7
KACL 500 / 600-30	30	20	65.1		53.1

**Übersicht Schieberkraft / Rückzugskraft
Table of Cam Force**

Typ / Type	Modell / Model	α	Federkraft (kN) / Spring Force (kN)		Arbeitskraft (kN / tonF) / (kN / tonF) Work Force
			Anfangskraft / Initial Load	Endkraft / Final Load	
GS	SM0750.75 (SDT)	00° ~ 30°	0	19.8	313.6
GD	L70.075.T0.140 (Dadco)			18.6	
GK	K750-80-TD (Kaller)			17.6	

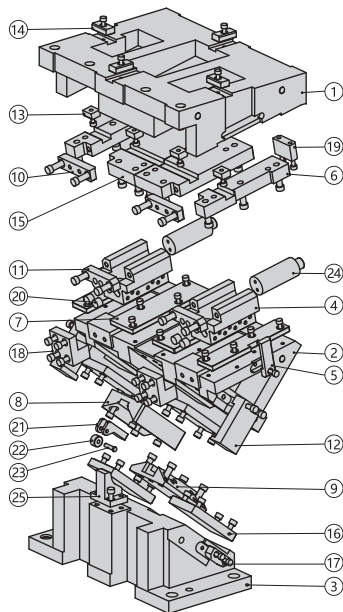

Nr. / No.	Beschreibung / Description	Anzahl / Qty	Material und Anmerkung / Material and Remark
①	Aufnahme / Cam Holder	1	HT300
②	Schieber / Cam Slider	1	HT300
③	Treiber / Cam Driver	1	HT300
④	Federführungsblock / Hanger	2	QT450+Festschmierstoff / graphite plugs
⑤	Sicherungsplatte / Safety Hook	2	45
⑥	Gleitplatte / Guide Block	4	20Cr
⑦	Gleitplatte / Guide Block	4	Bronze+Festschmierstoff / graphite plugs
⑧	Gleitstück / U Cam Slide Guide	1	20Cr
⑨	V-Prisma / V Cam Slide Guide	1	Bronze+Festschmierstoff / graphite plugs
⑩	Halteplatte / Stopping Block	2	St45
⑪	Platte / Spring Rxed Plate	2	St45
⑫	Zwangsrückführung / Position Return Follower	2	St45
⑬	Passfeder / Key	4	St45
⑭	Passfeder / Key	4	St45
⑮	Gleitplatte / Guide Block	2	42CrMo
⑯	Gleitplatte / Guide Block	2	Bronze+Festschmierstoff / graphite plugs
⑰	Zwangsrückführung / Position Return Follower	2	Bronze+Festschmierstoff / graphite plugs
⑱	Stopblock / Stopper	2	St45
⑲	Distanzplatte / Nitrogen Cylinder Top Block	2	St45
⑳	Urethan-Dämpfer / Urethane Stopper	4	Urethan
㉑	Rollenblock / Roller Bracket	1	St45
㉒	Rolle / Roller	1	GCr15
㉓	Rollenachse / Roller Pin	1	St45
㉔	Feder / Spring	1	Typ / Type
㉕	Beschleuniger / Guide	1	St45

Bestellnummer / Order Number

	Bestellnr. / Catalog No.	-	(W)	-	(α)	-	Typ / Type
	KACL	-	500	-	30	-	GK
	KACL	-	600	-	30	-	GK

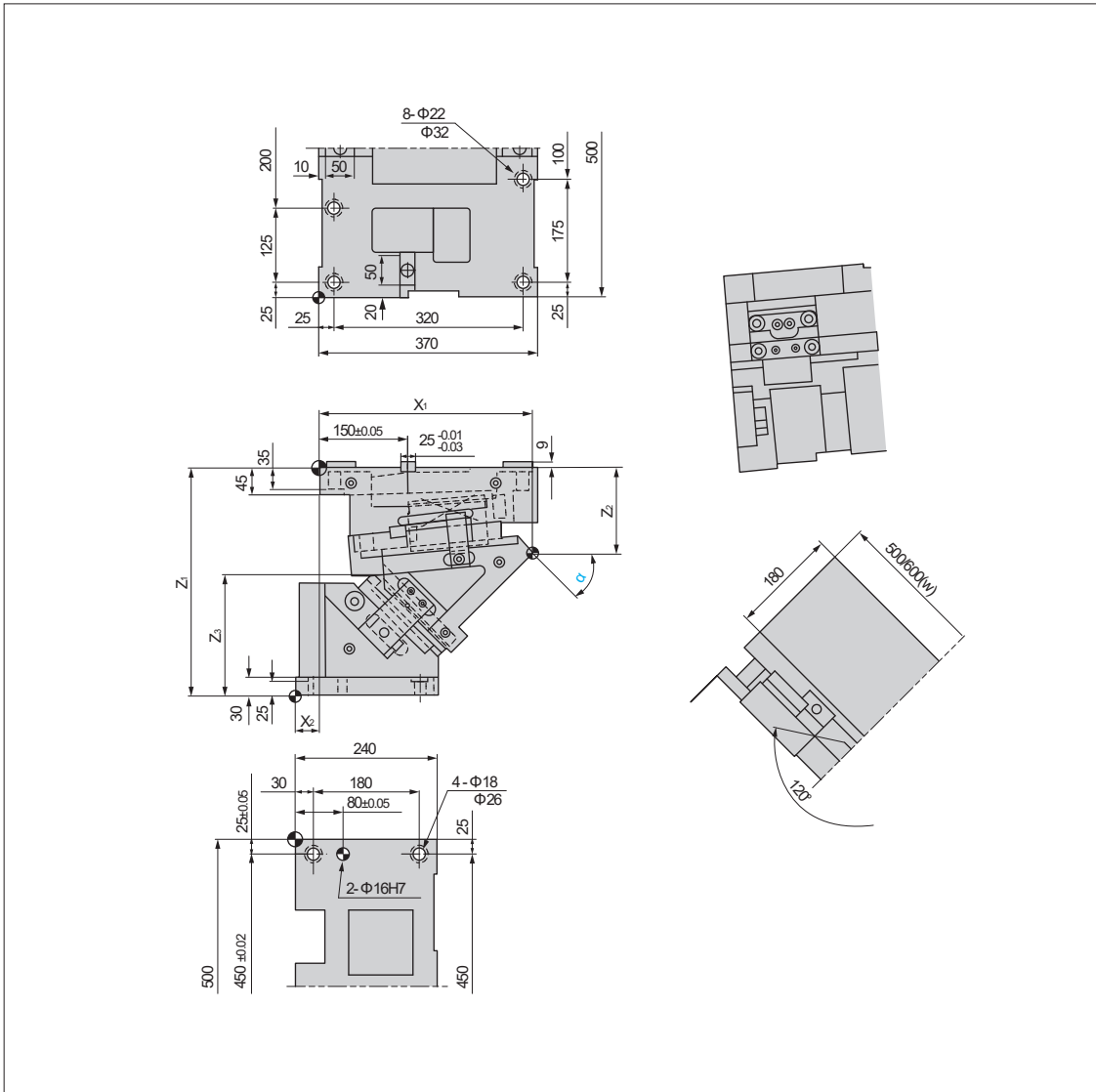

KACL500 / 600

**Tabelle Schieber
Table of Cam Structure**

Bestellnr. / Catalog No.	W	X ₁	X ₂	Z ₁	Z ₂	Z ₃	Gewicht (kg) / Weight (kg)
KACL 500 / 600-35	500 / 600	353.80	-15	385	116.44	189.4	269.9 / 276.7
KACL 500 / 600-40	500 / 600	355.40	-30	385	130.16	198.5	274.5 / 281.3
KACL 500 / 600-45	500 / 600	361.02	-40	385	145.29	207.8	281.6 / 288.5
KACL 500 / 600-50	500 / 600	355.12	-60	385	161.72	213.7	282.0 / 288.9
KACL 500 / 600-55	500 / 600	367.74	-60	385	179.31	216.6	291.5 / 299.2
KACL 500 / 600-60	500 / 600	378.77	-60	385	197.93	223.6	300.1 / 308.7

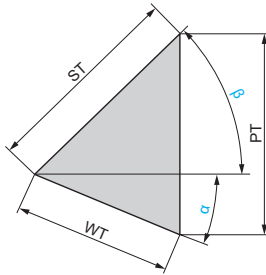



Bestellnr. / Catalog No.	α	β	WT	ST	PT
KACL 500 / 600-35	35	15	70.8	60	56.1
KACL 500 / 600-40	40	10	77.1		60.0
KACL 500 / 600-45	45	5	84.5		65.0
KACL 500 / 600-50	50	0	93.3		71.5
KACL 500 / 600-55	55	0	104.6		85.7
KACL 500 / 600-60	60	0	120		103.9

**Übersicht Schieberkraft / Rückzugskraft
Table of Cam Force**

Typ / Type	Modell / Model	α	Federkraft (kN) / Spring Force (KN)		Arbeitskraft (kN / tonF) / (KN / tonF) Work Force
			Anfangskraft / Initial Load	Endkraft / Final Load	
GS	SM0750.75 (SDT)	35° ~ 60°	0	19.8	313.6
GD	L70.075.T0.140 (Dadco)			18.6	
GK	K750-80-TD (Kaller)			17.6	

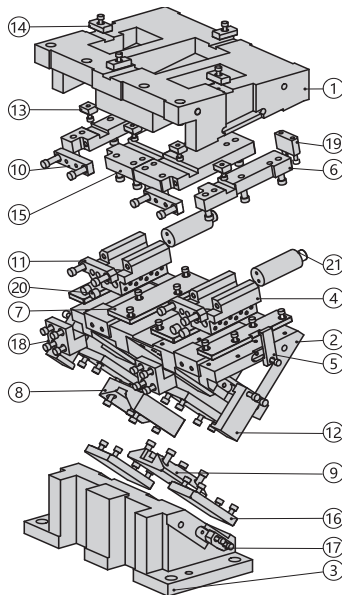

Nr. / No.	Beschreibung / Description	Anzahl / Qty	Material und Anmerkung / Material and Remark
①	Aufnahme / Cam Holder	1	HT300
②	Schieber / Cam Slider	1	HT300
③	Treiber / Cam Driver	1	HT300
④	Federführungsblock / Hanger	2	QT450
⑤	Sicherungsplatte / Safety Hook	2	St45
⑥	Gleitplatte / Guide Block	4	20Cr
⑦	Gleitplatte / Guide Block	4	Bronze+Festschmierstoff / graphite plugs
⑧	Gleitstück / U Cam Slide Guide	1	20Cr
⑨	V-Prisma / V Cam Slide Guide	1	Bronze+Festschmierstoff / graphite plugs
⑩	Halteplatte / Stopping Block	2	St45
⑪	Platte / Spring Rxed Plate	2	St45
⑫	Zwangsrückführung / Position Return Follower	2	St45
⑬	Passfeder / Key	4	St45
⑭	Passfeder / Key	4	St45
⑮	Gleitplatte / Guide Block	2	42CrMo
⑯	Gleitplatte / Guide Block	2	Bronze+Festschmierstoff / graphite plugs
⑰	Zwangsrückführung / Position Return Follower	2	Bronze+Festschmierstoff / graphite plugs
⑱	Stopblock / Stopper	2	St45
⑲	Distanzplatte / Nitrogen Cylinder Top Block	2	St45
⑳	Urethan-Dämpfer / Urethane Stopper	4	Urethan
㉑	Feder / Spring	1	Typ / Type

Bestellnummer / Order Number

	Bestellnr. / Catalog No.	-	(W)	-	(α)	-	Typ / Type
	KACL	-	500	-	40	-	GK
	KACL	-	600	-	40	-	GK

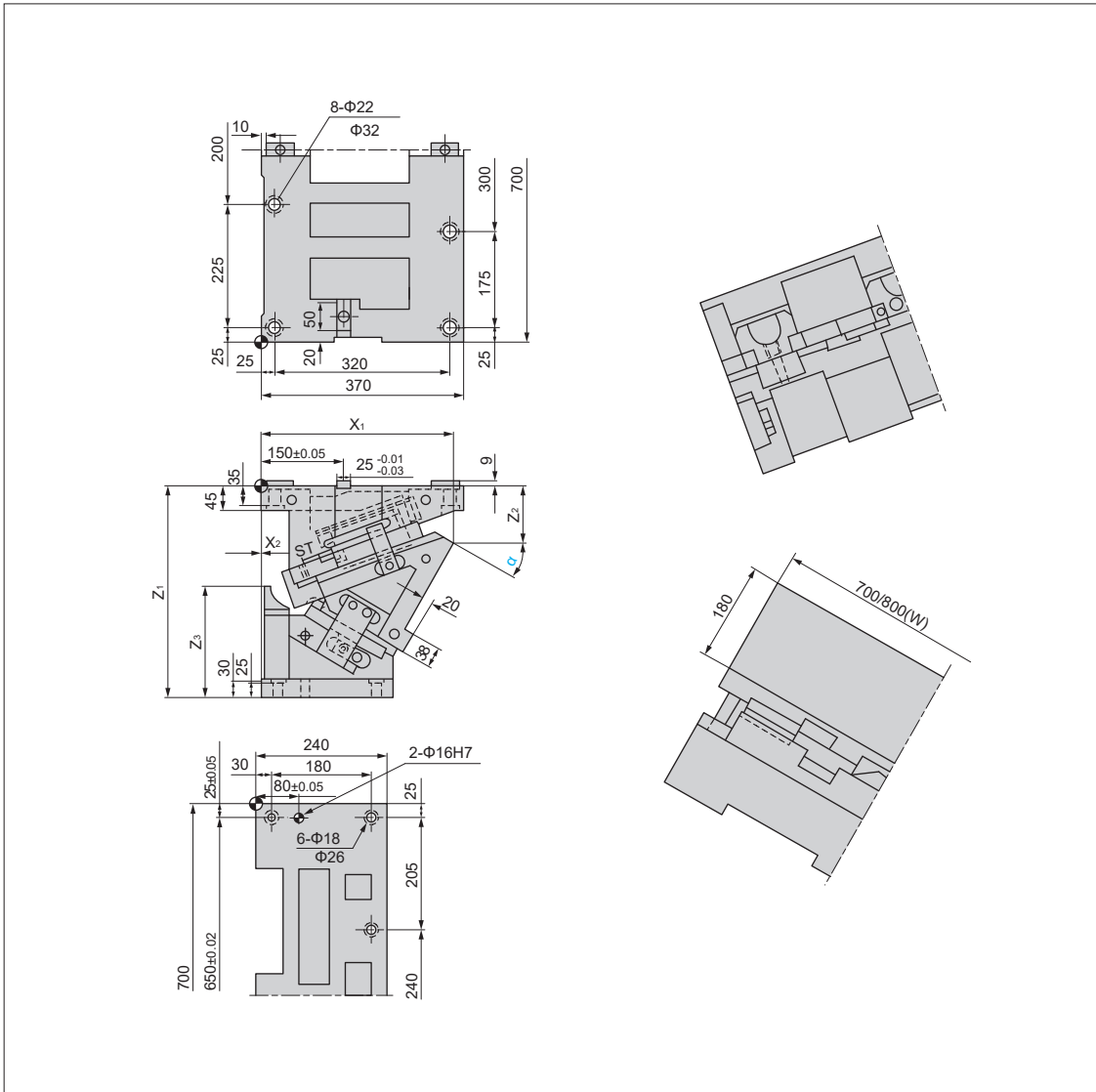

KACL700 / 800

**Tabelle Schieber
Table of Cam Structure**

Bestellnr. / Catalog No.	W	X ₁	X ₂	Z ₁	Z ₂	Z ₃	Gewicht (kg) / Weight (kg)
KACL700 / 800-00	700 / 800	323.00	95	385	57.00	110.00	362.6 / 369.4
KACL 700 / 800-05	700 / 800	329.58	80	385	58.64	132.00	358.9 / 365.7
KACL 700 / 800-10	700 / 800	335.94	65	385	62.16	145.00	357.2 / 364
KACL 700 / 800-15	700 / 800	341.91	50	385	67.52	170.00	357.0 / 363.8
KACL 700 / 800-20	700 / 800	347.34	35	385	74.69	182.00	356.1 / 363
KACL 700 / 800-25	700 / 800	347.06	15	385	83.62	210.00	357.3 / 364.2
KACL 700 / 800-30	700 / 800	350.93	0	385	104.23	219.00	362.7 / 369.5

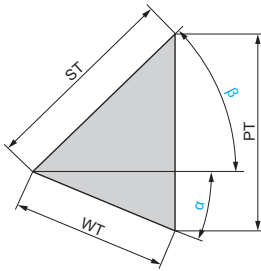



Bestellnr. / Catalog No.	α	β	WT	ST	PT
KACL 700 / 800-00	0	50	38.6	60	46.0
KACL 700 / 800-05	5	45	42.6		46.1
KACL 700 / 800-10	10	40	46.7		46.7
KACL 700 / 800-15	15	35	50.9		47.6
KACL 700 / 800-20	20	30	55.3		48.9
KACL 700 / 800-25	25	25	60.0		50.7
KACL 700 / 800-30	30	20	65.1		53.1

Übersicht Schieberkraft / Rückzugskraft Table of Cam Force

Typ / Type	Modell / Mode	α	Federkraft (kN) / Spring Force (KN)		Arbeitskraft (kN / tonF) / (KN / tonF) Work Force
			Anfangskraft / Initial Load	Endkraft / Final Load	
GS	SM0750.75 (SDT)	00° ~ 30°	0	29.7	470.4
GD	L70.075.T0.140 (Dadco)			27.9	
GK	K750-80-TD (Kaller)			24.7	

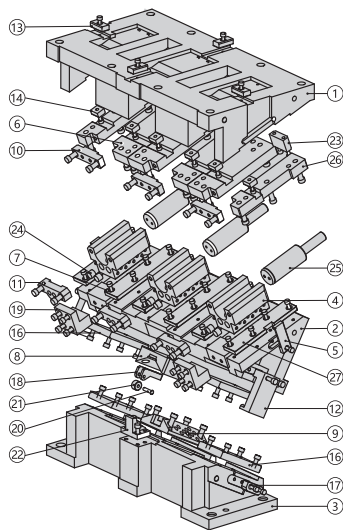

Nr. / No.	Beschreibung / Description	Anzahl / Qty	Material und Anmerkung / Material and Remark
①	Aufnahme / Cam Holder	1	HT300
②	Schieber / Cam Slider	1	HT300
③	Treiber / Cam Driver	1	HT300
④	Federführungsblock / Hanger	3	QT450+Festschmierstoff / graphite plugs
⑤	Sicherungsplatte / Safety Hook	2	St45
⑥	Gleitplatte / Guide Block	4	20Cr
⑦	Gleitplatte / Guide Block	4	Bronze+Festschmierstoff / graphite plugs
⑧	Gleitstück / U Cam Slide Guide	1	20Cr
⑨	V-Prisma / V Cam Slide Guide	1	Bronze+Festschmierstoff / graphite plugs
⑩	Halteplatte / Stopping Block	3	St45
⑪	Platte / Spring Rxed Plate	3	St45
⑫	Zwangsrückführung / Position Return Follower	2	St45
⑬	Passfeder / Key	4	St45
⑭	Passfeder / Key	6	St45
⑮	Gleitplatte / Guide Block	2	42CrMo
⑯	Gleitplatte / Guide Block	2	Bronze+Festschmierstoff / graphite plugs
⑰	Zwangsrückführung / Position Return Follower	2	Bronze+Festschmierstoff / graphite plugs
⑱	Rollenblock / Roller Installing Seat	1	St45
⑲	Stopblock / Stopper	2	St45
⑳	Rollenachse / Rotation Axis	1	St45
㉑	Rolle / Roller	1	St45
㉒	Beschleuniger / Guide	1	St45
㉓	Distanzplatte / Nitrogen Cylinder Top Block	3	St45
㉔	Urethan-Dämpfer / Urethane Stopper	6	Urethan
㉕	Gasdruckfeder / Nitrogen Cylinder	3	Typ / Type
㉖	Gleitplatte / Guide Block	2	20Cr
㉗	Gleitplatte / Guide Block	2	Bronze+Festschmierstoff / graphite plugs

Bestellnummer / Order Number

	Bestellnr. / Catalog No.	-	(W)	-	(α)	-	Typ / Type
	KACL	-	700	-	30	-	GK
	KACL	-	800	-	30	-	GK

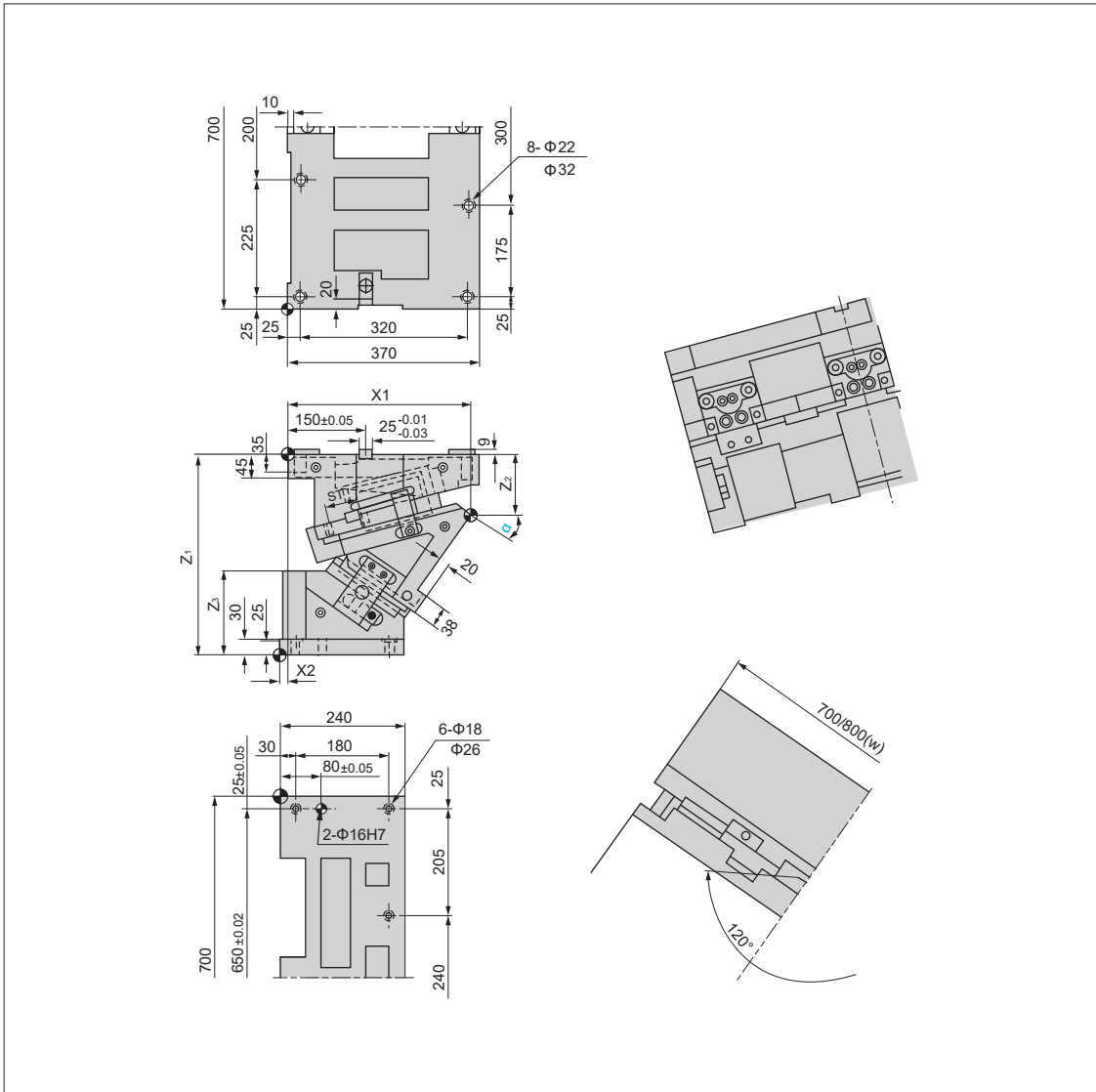

KACL700 / 800

**Tabelle Schieber
Table of Cam Structure**

Bestellnr. / Catalog No.	W	X ₁	X ₂	Z ₁	Z ₂	Z ₃	Gewicht (kg) / Weight (kg)
KACL 700 / 800-35	700 / 800	353.80	-15	385	116.44	190.30	370.6 / 377.4
KACL 700 / 800-40	700 / 800	355.54	-30	385	130.16	199.54	377.0 / 383.8
KACL 700 / 800-45	700 / 800	361.02	-40	385	145.29	207.80	383.6 / 390.4
KACL 700 / 800-50	700 / 800	355.12	-60	385	161.72	212.70	386.5 / 393.4
KACL 700 / 800-55	700 / 800	367.74	-60	385	179.31	218.30	400.8 / 408.3
KACL 700 / 800-60	700 / 800	378.77	-60	385	197.93	225.00	412.7 / 421.2

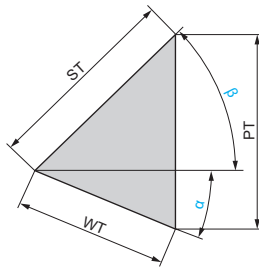



Bestellnr. / Catalog No.	α	β	WT	ST	PT
KACL 700 / 800-35	35	15	70.8	60	56.1
KACL 700 / 800-40	40	10	77.1		60.0
KACL 700 / 800-45	45	5	84.5		65.0
KACL 700 / 800-50	50	0	93.3		71.5
KACL 700 / 800-55	55	-5	104.6		85.7
KACL 700 / 800-60	60	10	120		103.9

**Übersicht Schieberkraft / Rückzugskraft
Table of Cam Force**

Typ / Type	Modell / Model	α	Federkraft (kN) / Spring Force (KN)		Arbeitskraft (kN / tonF) / (KN / tonF) Work Force
			Anfangskraft / Initial Load	Endkraft / Final Load	1 Mio. HÜBE / strokes Standard-Arbeitskraft / Standard Working Force
GS	SM0750.75 (SDT)	35° ~ 60°	0	29.7	470.4
GD	L70.075.T0.140 (Dadco)			27.9	
GK	K750-80-TD (Kaller)			24.7	

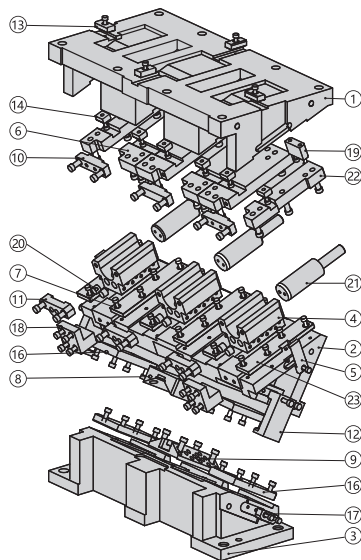

Nr. / No.	Beschreibung / Description	Anzahl / Qty	Material und Anmerkung / Material and Remark
①	Aufnahme / Cam Holder	1	HT300
②	Schieber / Cam Slider	1	HT300
③	Treiber / Cam Driver	1	HT300
④	Federführungsblock / Hanger	3	QT450+Festschmierstoff / graphite plugs
⑤	Sicherungsplatte / Safety Hook	2	St45
⑥	Gleitplatte / Guide Block	4	20Cr
⑦	Gleitplatte / Guide Block	4	Bronze+Festschmierstoff / graphite plugs
⑧	Gleitstück / U Cam Slide Guide	1	20Cr
⑨	V-Prisma / V Cam Slide Guide	1	Bronze+Festschmierstoff / graphite plugs
⑩	Halteplatte / Stopping Block	3	St45
⑪	Platte / Spring Rxed Plate	3	St45
⑫	Zwangsrückführung / Position Return Follower	2	St45
⑬	Passfeder / Key	4	St45
⑭	Passfeder / Key	6	St45
⑮	Gleitplatte / Guide Block	2	42CrMo
⑯	Gleitplatte / Guide Block	2	Bronze+Festschmierstoff / graphite plugs
⑰	Zwangsrückführung / Position Return Follower	2	Bronze+Festschmierstoff / graphite plugs
⑱	Stopblock / Stopper	2	St45
⑲	Distanzplatte / Nitrogen Cylinder Top Block	3	St45
⑳	Urethan-Dämpfer / Urethane Stopper	6	Urethan
㉑	Gasdruckfeder / Nitrogen Cylinder	3	Typ / Type
㉒	Gleitplatte / Guide Block	2	20Cr
㉓	Gleitplatte / Guide Block	2	Bronze+Festschmierstoff / graphite plugs

Bestellnummer / Order Number

	Bestellnr. / Catalog No.	-	(W)	-	(α)	-	Typ / Type
	KACL	-	700	-	40	-	GK
	KACL	-	800	-	40	-	GK

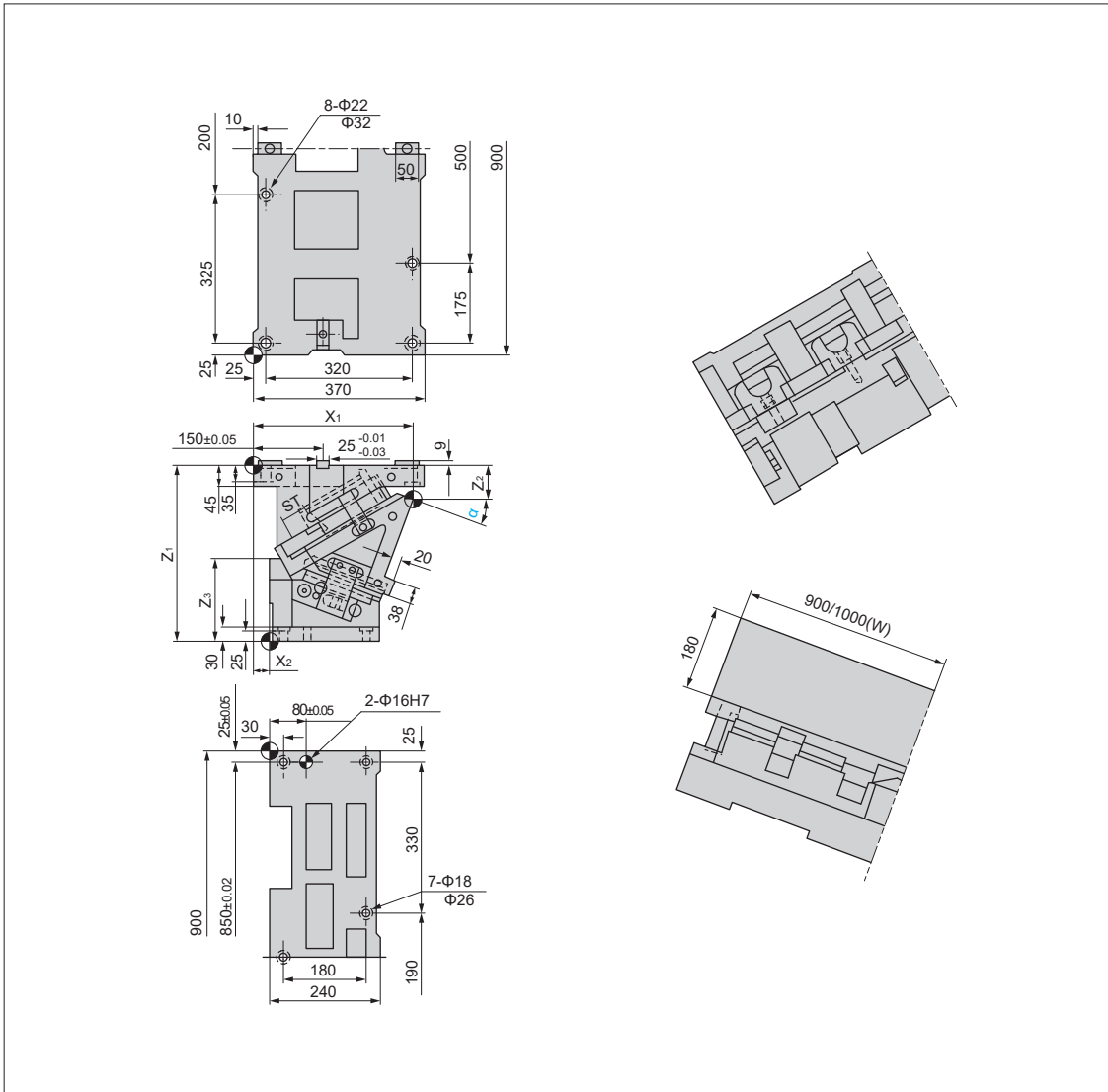

KACL900 / 1000

**Tabelle Schieber
Table of Cam Structure**

Bestellnr. / Catalog No.	W	X ₁	X ₂	Z ₁	Z ₂	Z ₃	Gewicht (kg) / Weight (kg)
KACL900 / 1000-00	900 / 1000	323.00	95	385	57.00	110.00	463.3 / 470.2
KACL 900 / 1000-05	900 / 1000	329.58	80	385	58.64	132.00	459.2 / 466.1
KACL 900 / 1000-10	900 / 1000	335.94	65	385	62.16	145.00	457.7 / 464.6
KACL 900 / 1000-15	900 / 1000	341.91	50	385	67.52	170.00	457.8 / 464.7
KACL 900 / 1000-20	900 / 1000	347.34	35	385	74.69	182.00	459.7 / 466.5
KACL 900 / 1000-25	900 / 1000	347.06	15	385	83.62	210.00	461.5 / 468.4
KACL 900 / 1000-30	900 / 1000	350.93	0	385	104.23	219.00	467.8 / 474.7

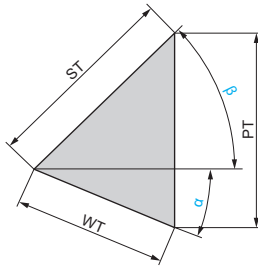



Bestellnr. / Catalog No.	α	β	WT	ST	PT
KACL900 / 1000-00	0	50	38.6	60	46.0
KACL 900 / 1000-05	5	45	42.6		46.1
KACL 900 / 1000-10	10	40	46.7		46.7
KACL 900 / 1000-15	15	35	50.9		47.6
KACL 900 / 1000-20	20	30	55.3		48.9
KACL 900 / 1000-25	25	25	60.0		50.7
KACL 900 / 1000-30	30	20	65.1		53.1

**Übersicht Schieberkraft / Rückzugskraft
Table of Cam Force**

Typ / Type	Modell / Model	α	Federkraft (kN) / Spring Force (KN)		Arbeitskraft (kN / tonF) / (KN / tonF) Work Force
			Anfangskraft / Initial Load	Endkraft / Final Load	1 Mio. Hübe / strokes Standard-Arbeitskraft / Standard Working Force
GS	SM0750.75 (SDT)	00° ~ 30°	0	39.7	627.2
GD	L70.075.T0.140 (Dadco)			37.2	
GK	K750-80-TD (Kaller)			33	

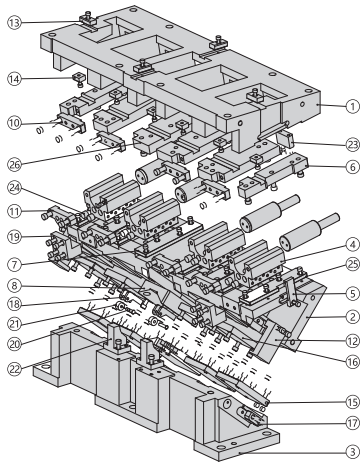

Nr. / No.	Beschreibung / Description	Anzahl / Qty	Material und Anmerkung / Material and Remark
①	Aufnahme / Cam Holder	1	HT300
②	Schieber / Cam Slider	1	HT300
③	Treiber / Cam Driver	1	HT300
④	Federführungsblock / Hanger	4	QT450+Festschmierstoff / graphite plugs
⑤	Sicherungsplatte / Safety Hook	2	St45
⑥	Gleitplatte / Guide Block	2	20Cr
⑦	Gleitplatte / Guide Block	6	Bronze+Festschmierstoff / graphite plugs
⑧	Gleitstück / U Cam Slide Guide	1	20Cr
⑨	V-Prisma / V Cam Slide Guide	1	Bronze+Festschmierstoff / graphite plugs
⑩	Halteplatte / Stopping Block	4	St45
⑪	Platte / Nitrogen Spring Block	4	St45
⑫	Zwangsrückführung / Position Return Follower	2	St45
⑬	Passfeder / Key	4	St45
⑭	Passfeder / Key	6	St45
⑮	Gleitplatte / Guide Block	4	42CrMo
⑯	Gleitplatte / Guide Block	4	Bronze+Festschmierstoff / graphite plugs
⑰	Zwangsrückführung / Position Return Follower	2	Bronze+Festschmierstoff / graphite plugs
⑱	Rollenblock / Roller Installing Seat	2	St45
⑲	Stopblock / Stopper	2	St45
⑳	Rollenachse / Rotation Axis	2	St45
㉑	Rolle / Roller	2	St45
㉒	Beschleuniger / Guide	2	St45
㉓	Distanzplatte / Nitrogen Cylinder Top Block	4	St45
㉔	Urethan-Dämpfer / Urethane Stopper	8	Urethan
㉕	Gleitplatte / Guide Block	2	Bronze+Festschmierstoff / graphite plugs
㉖	Gleitplatte / Guide Block	2	42CrMo
㉗	Gasdruckfeder / Gas Spring	4	Typ / Type

Bestellnummer / Order Number

	Bestellnr. / Catalog No.	-	(W)	-	(α)	-	Typ / Type
	KACL	-	900	-	30	-	GK
	KACL	-	1000	-	30	-	GK

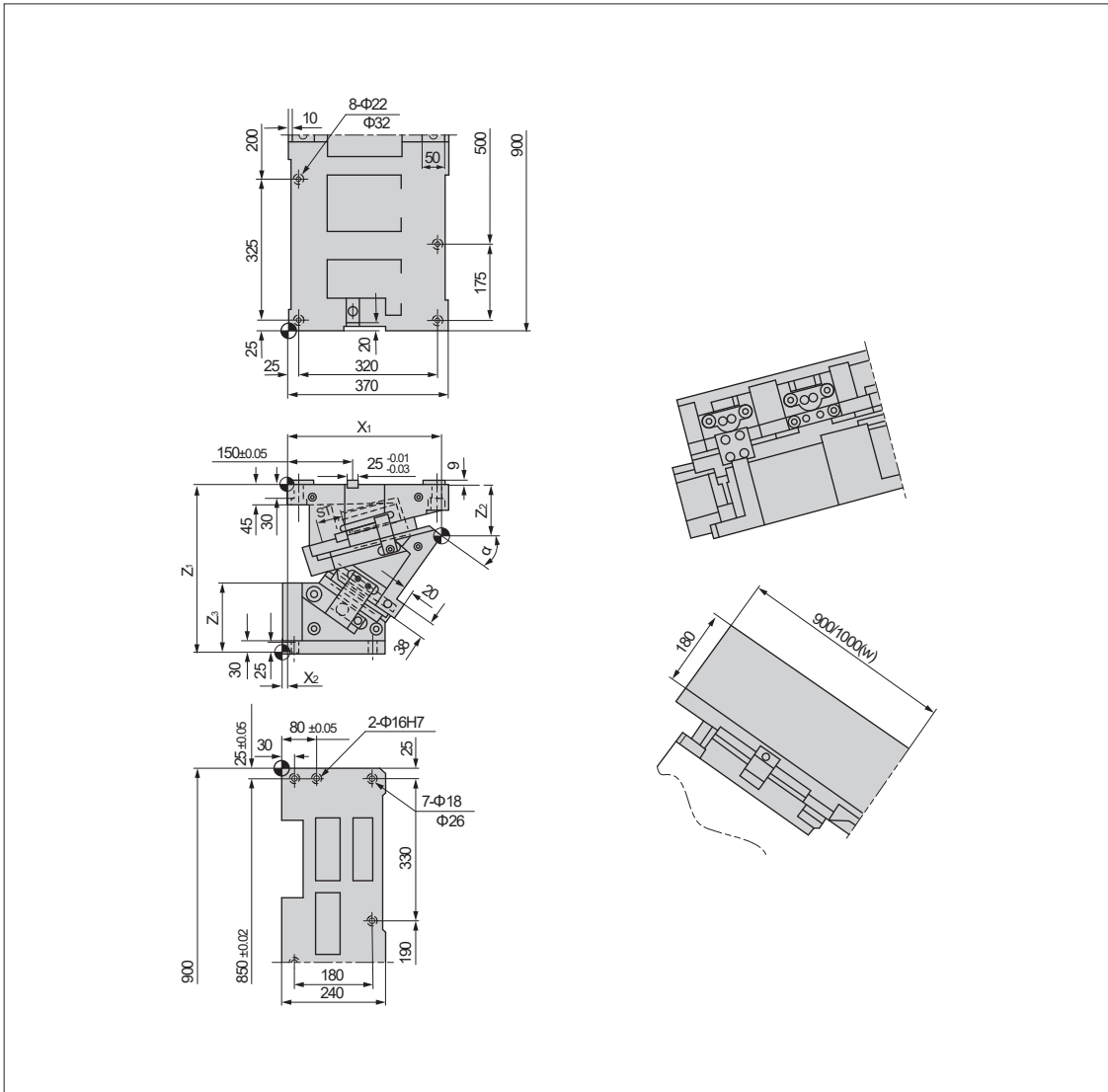

KACL900 / 1000

**Tabelle Schieber
Table of Cam Structure**

Bestellnr. / Catalog No.	W	X ₁	X ₂	Z ₁	Z ₂	Z ₃	Gewicht (kg) / Weight (kg)
KACL900 / 1000-35	900 / 1000	353.8	-15	385	116.21	190.30	478.9 / 485.8
KACL 900 / 1000-40	900 / 1000	355.54	-30	385	130.16	186.11	487.3 / 494.2
KACL 900 / 1000-45	900 / 1000	361.02	-40	385	145.29	207.80	499.4 / 506.3
KACL 900 / 1000-50	900 / 1000	355.12	-60	385	161.72	215.00	498.4 / 505.3
KACL 900 / 1000-55	900 / 1000	367.74	-60	385	179.31	218.30	519.2 / 526.9
KACL 900 / 1000-60	900 / 1000	378.77	-60	385	197.93	223.60	535.2 / 543.1

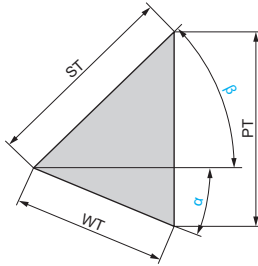



Bestellnr. / Catalog No.	α	β	WT	ST	PT
KACL 900 / 1000-35	35	15	70.8	60	56.1
KACL 900 / 1000-40	40	10	77.1		60.0
KACL 900 / 1000-45	45	5	84.5		65.0
KACL 900 / 1000-50	50	0	93.3		71.5
KACL 900 / 1000-55	55	0	104.6		85.7
KACL 900 / 1000-60	60	0	120.0		103.9

**Übersicht Schieberkraft / Rückzugskraft
Table of Cam Force**

Typ / Type	Modell / Model	α	Federkraft (kN) / Spring Force (KN)		Arbeitskraft (kN / tonF) / (KN / tonF) Work Force
			Anfangskraft / Initial Load	Endkraft / Final Load	1 Mio. Hübe / strokes Standard-Arbeitskraft / Standard Working Force
GS	SM0750.75 (SDT)	35° ~ 60°	0	39.7	627.2
GD	L70.075.T0.140 (Dadco)			37.2	
GK	K750-80-TD (Kaller)			33	

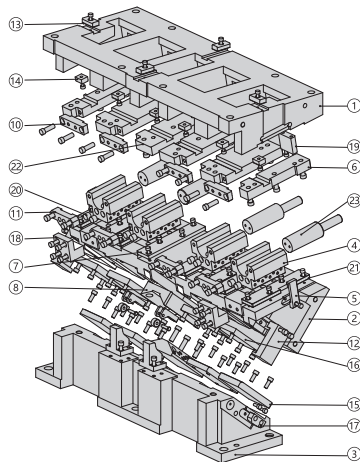

Nr. / No.	Beschreibung / Description	Anzahl / Qty	Material und Anmerkung / Material and Remark
①	Aufnahme / Cam Holder	1	HT300
②	Schieber / Cam Slider	1	HT300
③	Treiber / Cam Driver	1	HT300
④	Federführungsblock / Hanger	4	QT450+Festschmierstoff / graphite plugs
⑤	Sicherungsplatte / Safety Hook	2	St45
⑥	Gleitplatte / Guide Block	2	20Cr
⑦	Gleitplatte / Guide Block	6	Bronze+Festschmierstoff / graphite plugs
⑧	Gleitstück / U Cam Slide Guide	1	20Cr
⑨	V-Prisma / V Cam Slide Guide	1	Bronze+Festschmierstoff / graphite plugs
⑩	Halteplatte / Stopping Block	4	St45
⑪	Platte / Nitrogen Spring Block	4	St45
⑫	Zwangsrückführung / Position Return Follower	2	St45
⑬	Passfeder / Key	4	St45
⑭	Passfeder / Key	6	St45
⑮	Gleitplatte / Guide Block	4	42CrMo
⑯	Gleitplatte / Guide Block	4	Bronze+Festschmierstoff / graphite plugs
⑰	Zwangsrückführung / Position Return Follower	2	Bronze+Festschmierstoff / graphite plugs
⑱	Stoppblock / Stopper	2	St45
⑲	Distanzplatte / Nitrogen Cylinder Top Block	4	St45
⑳	Urethan-Dämpfer / Urethane Stopper	8	Urethan
㉑	Gleitplatte / Guide Block	2	Bronze+Festschmierstoff / graphite plugs
㉒	Gleitplatte / Guide Block	2	42CrMo
㉓	Gasdruckfeder / Gas Spring	4	Typ / Type

Bestellnummer / Order Number

	Bestellnr. / Catalog No.	-	(W)	-	(α)	-	Typ / Type
	KACL	-	900	-	40	-	GK
	KACL	-	1000	-	40	-	GK

