

KACNR70

**Tabelle Schieber
Table of Cam Structure**

Bestellnr. / Catalog No.	W	X ₁	X ₂	X ₃	X ₄	Z ₁	Z ₂	Z ₃	Z ₄	Z ₅	Gewicht (kg) / Weight (kg)
KACNR70-00	70	237.37	102	147.37	155.5	225	85.00	46.4	120	35.00	16.1
KACNR70-05	70	234.87	92	151.53	149.5	225	86.28	53.9	125	37.82	15.4
KACNR70-10	70	232.82	81	156.74	145.0	225	88.76	60.9	130	39.76	14.8
KACNR70-15	70	217.54	57	162.67	140.5	225	96.59	63.1	135	36.55	14.1
KACNR70-20	70	224.52	52	170.62	134.5	225	99.67	70.5	140	38.55	14.1
KACNR70-25	70	223.46	42	176.26	130.0	225	105.45	75.7	145	38.04	14.0
KACNR70-30	70	211.54	30	174.03	125.5	225	112.99	79.4	150	35.81	13.8
KACNR70-35	70	210.68	17	181.86	119.5	225	117.2	86.8	155	37.74	13.7
KACNR70-40	70	204.84	4	187.19	115.0	225	125.07	90.6	160	35.53	13.8
KACNR70-45	70	198.15	-2	183.40	110.5	225	131.28	96.1	165	35.68	13.8
KACNR70-50	70	190.95	-21	189.08	106.0	225	135.15	104.0	170	39.92	13.9
KACNR70-55	70	190.51	-23	193.02	101.5	225	146.01	104.8	175	33.41	14.1
KACNR70-60	70	185.81	-35	202.99	98.5	225	155.86	106.3	180	27.50	14.5

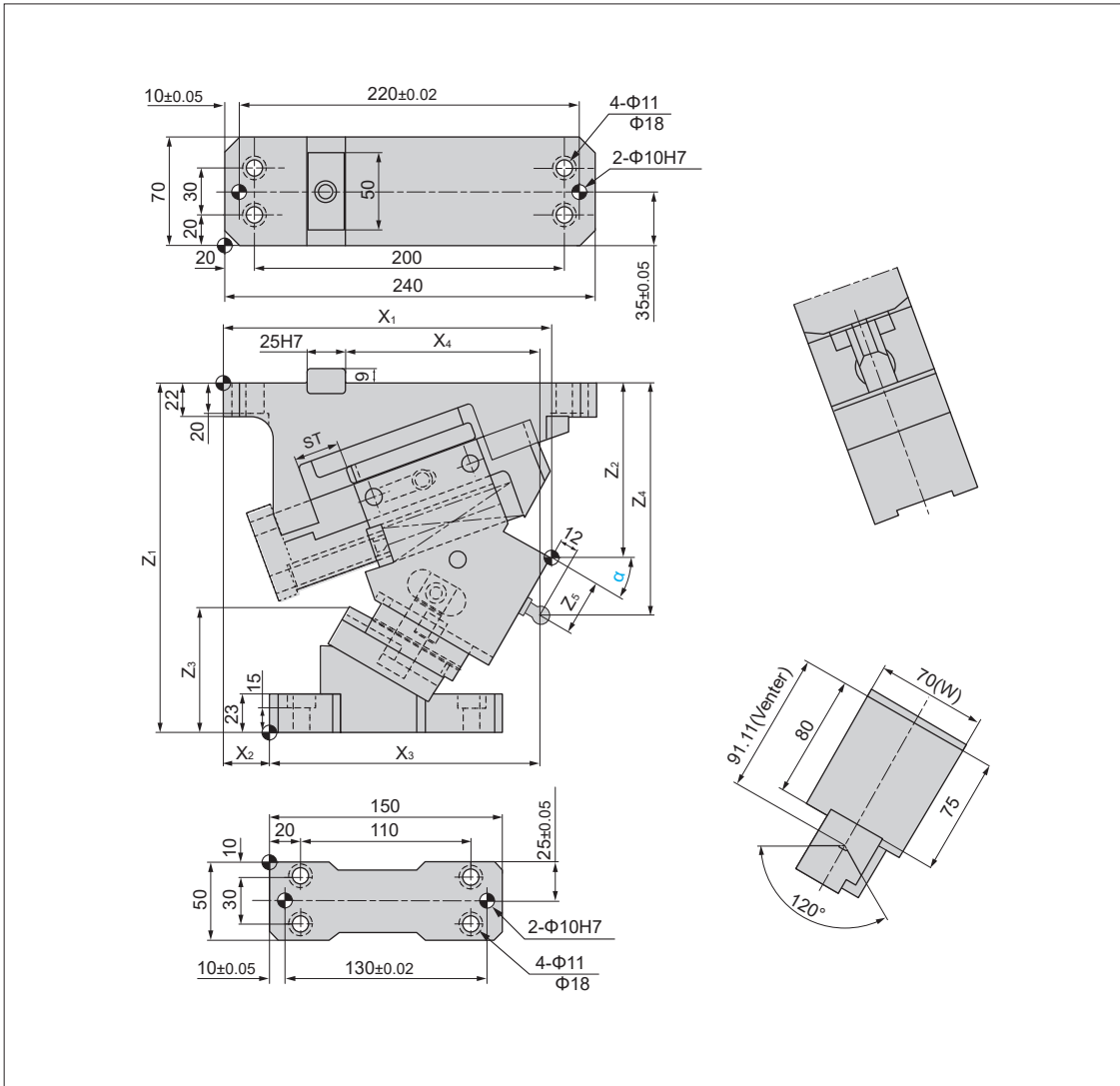

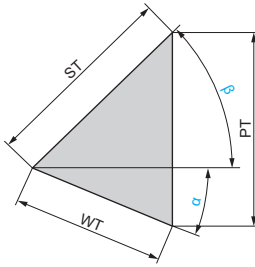

Bestellnr. / Catalog No.	α	β	WT	ST	PT
KACNR70-00	0	50	19.3	30	22.9
KACNR70-05	5	45	21.3		23.1
KACNR70-10	10	40	23.3		23.3
KACNR70-15	15	35	25.4		23.8
KACNR70-20	20	30	27.6		24.5
KACNR70-25	25	25	30.0		25.4
KACNR70-30	30	20	32.6		26.5
KACNR70-35	35	15	35.4		28.1
KACNR70-40	40	10	38.6		30.0
KACNR70-45	45	5	42.3		32.5
KACNR70-55	50	0	46.7		35.8
KACNR70-55	55		43.6		25
KACNR70-60	60		50.0	43.3	

Übersicht Schieberkraft / Rückzugskraft Table of Cam Force

Typ / Type	α	Federkraft (N/kgf) / Spring Force (N / kgf)		Arbeitskraft (kN / tonF) / (KN / tonF) Work Force
		Anfangskraft / Initial Load	Endkraft / Final Load	
Schraubendruckfeder / Coil Spring	00° ~ 60°	68.6 / 7.0	657.0 / 67.0	98.1 / 10.0
GK KALLER		—	2350.0 / 239.6	

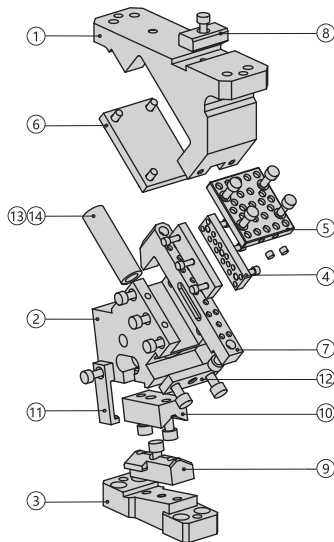

Nr. / No.	Beschreibung / Description	Anzahl / Qty	Material und Anmerkung / Material and Remark
①	Aufnahme / Cam Holder	1	QT450
②	Schieber / Cam Slider	1	QT450
③	Treiber / Cam Driver	1	QT450
④	Gleitplatte / Guide Block	2	Bronze+Festschmierstoff / graphite plugs
⑤	Gleitplatte / Guide Block	1	Bronze+Festschmierstoff / graphite plugs
⑥	Gleitplatte / Guide Block	1	42CrMo
⑦	Führungsleiste / Guide Rod	1	Stahl 45+Festschmierstoff / graphite plugs
⑧	Passfeder / Key	1	42CrMo
⑨	V-Prisma / V Cam Slide Guide	1	Bronze+Festschmierstoff / graphite plugs
⑩	V-Prisma / V Cam Slide Guide	1	St45
⑪	Zwangsrückführung / Positive Return Follower	1	St45
⑫	Federblock / Spring Block	1	St45
⑬	Feder / Spring	1	Typ (s. Options-Code) / Type
⑭	Federblock / Spring Block	1	St45
⑮	Step Plate / Step Plate	1	St45

Options-Code / Option Code	Beschreibung / Envelope	Modell / Model
GK	Gasdruckfeder KALLER / Fibro / Gas Spring by KALLER	M150-38.1
ISO	Schraubendruckfeder (Federrate = 19,6 N/mm) / Coil Spring (Spring rate = 19.6 N/mm)	TJL25-115

Bestellnummer / Order Number

	Bestellnr. / Catalog No.	-	(W)	-	(α)	-	Typ (s. Options-Code) / Type
	KACNR	-	70	-	30	-	GK



KACNR80

Tabelle Schieber
Table of Cam Structure

Bestellnr. / Catalog No.	W	X ₁	X ₂	X ₃	X ₄	Z ₂	Z ₂	Z ₃	Z ₄	Z ₅	Gewicht (kg) / Weight (kg)
KACNR80-00	80	280.00	135	157	180.0	275	110.00	69.0	155	45.00	27.9
KACNR80-05	80	281.31	125	164.5	160.5	275	115.93	73.5	160	43.19	27.5
KACNR80-10	80	277.50	110	171.37	153.0	275	117.84	82.6	165	45.77	26.9
KACNR80-15	80	280.48	105	174.7	144.0	275	120.72	91.3	170	47.80	26.5
KACNR80-20	80	276.16	95	175.57	136.5	275	124.55	99.6	175	49.32	26.0
KACNR80-25	80	271.47	80	181.07	127.5	275	129.29	107.3	180	50.35	25.9
KACNR80-30	80	264.33	65	184.27	120.0	275	134.92	114.5	185	50.90	25.3
KACNR80-35	80	260.66	55	186.26	112.5	275	141.38	120.9	190	50.95	25.0
KACNR80-40	80	252.32	35	193.34	105.0	275	147.76	126.8	195	51.60	24.7
KACNR80-45	80	247.46	30	191.04	99.0	275	156.61	131.8	200	49.36	24.7
KACNR80-50	80	237.80	15	194.12	93.0	275	165.27	136.1	205	47.51	24.9
KACNR80-55	80	231.36	0	201.62	72.0	275	174.53	139.6	210	44.70	25.8
KACNR80-60	80	233.95	0	207.53	79.0	275	185.89	140.7	215	37.43	26.2



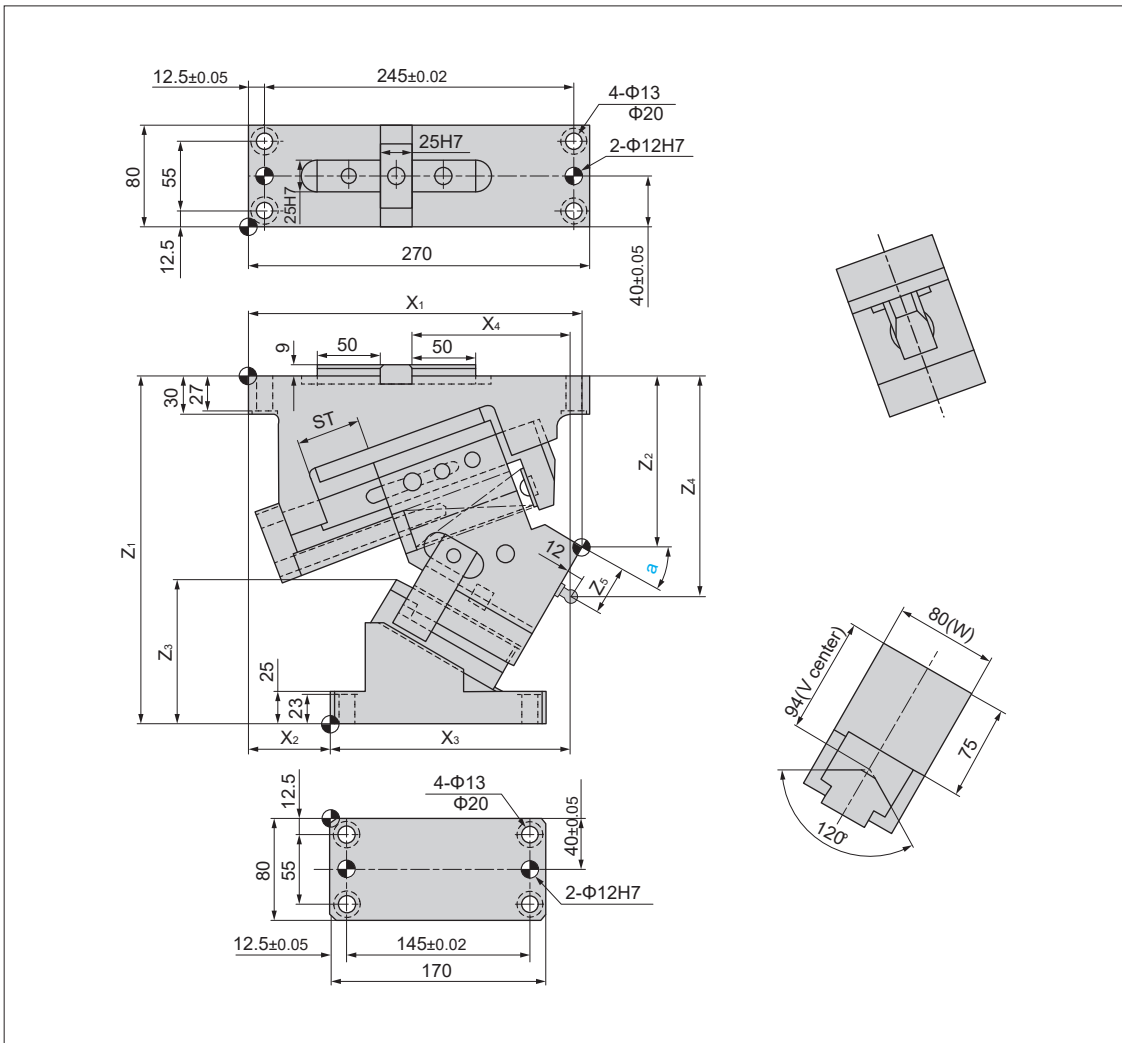
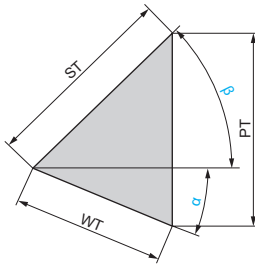

Bestellnr. / Catalog No.	α	β	WT	ST	PT	
KACNR80-00	0	50	32.1	50	38.3	
KACNR80-05	5	45	35.5		38.4	
KACNR80-10	10	40	38.9		38.9	
KACNR80-15	15	35	42.4		39.7	
KACNR80-20	20	30	46.1		40.8	
KACNR80-25	25	25	50.0		42.3	
KACNR80-30	30	20	54.3		44.2	
KACNR80-35	35	15	59.0		46.8	
KACNR80-40	40	10	64.3		50.0	
KACNR80-45	45	5	70.4		54.2	
KACNR80-50	50	0	77.8		59.6	
KACNR80-55	55		78.5		45	64.3
KACNR80-60	60		80.0		40	69.3

Übersicht Schieberkraft / Rückzugskraft Table of Cam Force

Typ / Type	α	Federkraft (N/kgf) / Spring Force (N / kgf)		Arbeitskraft (kN / tonF) / (KN / tonF) Work Force
		Anfangskraft / Initial Load	Endkraft / Final Load	
Schraubendruckfeder / Coil Spring	00° ~ 60°	73.5 / 7.5	1223.6 / 124.8	98.1 / 10.0
GK KALLER		—	2350.0 / 239.6	

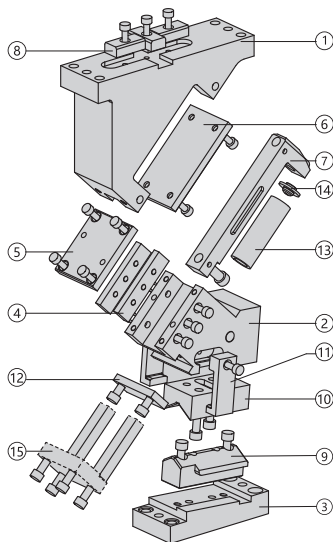

Nr. / No.	Beschreibung / Description	Anzahl / Qty	Material und Anmerkung / Material and Remark
①	Aufnahme / Cam Holder	1	QT450
②	Schieber / Cam Slider	1	QT450
③	Treiber / Cam Driver	1	QT450
④	Gleitplatte / Guide Block	2	Bronze+Festschmierstoff / graphite plugs
⑤	Gleitplatte / Guide Block	1	Bronze+Festschmierstoff / graphite plugs
⑥	Gleitplatte / Guide Block	1	42CrMo
⑦	Führungsleiste / Guide Rod	1	Stahl 45+Festschmierstoff / graphite plugs
⑧	Passfeder / Key	1	42CrMo
⑨	V-Prisma / V Cam Slide Guide	1	Bronze+Festschmierstoff / graphite plugs
⑩	V-Prisma / V Cam Slide Guide	1	St45
⑪	Zwangsrückführung / Positive Return Follower	1	St45
⑫	Federblock / Spring Block	1	St45
⑬	Feder / Spring	1	Typ (s. Options-Code) / Type
⑭	Federblock / Spring Block	1	St45
⑮	Befestigungs-Set / Step Plate	1	St45

Options-Code / Option Code	Beschreibung / Envelope	Modell / Model
GK	Gasdruckfeder KALLER/Fibro / Gas Spring by KALLER	M150-50
ISO	Schraubendruckfeder (Federrate = 23,0 N/mm) / Coil Spring (Spring rate = 23.0 N/mm)	TJL32-152

Bestellnummer / Order Number

	Bestellnr. / Catalog No.	(W)	(α)	Typ (s. Options-Code) / Type
	KACNR	80	30	GK





KACNR165



Tabelle Schieber
Table of Cam Structure

Bestellnr. / Catalog No.	W	X ₁	X ₂	X ₃	X ₄	Z ₁	Z ₂	Z ₃	Z ₄	Z ₅	Gewicht (kg) / Weight (kg)
KACNR165-00	165	335.84	128	55	180.5	300	96.98	80.0	170	73.02	76.1
KACNR165-05	165	335.25	113	55	173.0	300	100.91	98.0	175	73.32	74.2
KACNR165-10	165	337.27	101	50	165.5	300	111.09	109.0	180	67.86	73.8
KACNR165-15	165	329.78	80	45	156.5	300	122.46	120.0	185	61.53	73.1
KACNR165-20	165	332.68	70	42	149.0	300	129.99	137.0	190	59.49	72.3
KACNR165-25	165	332.88	58	37	140.0	300	138.62	154.0	195	56.61	72.1



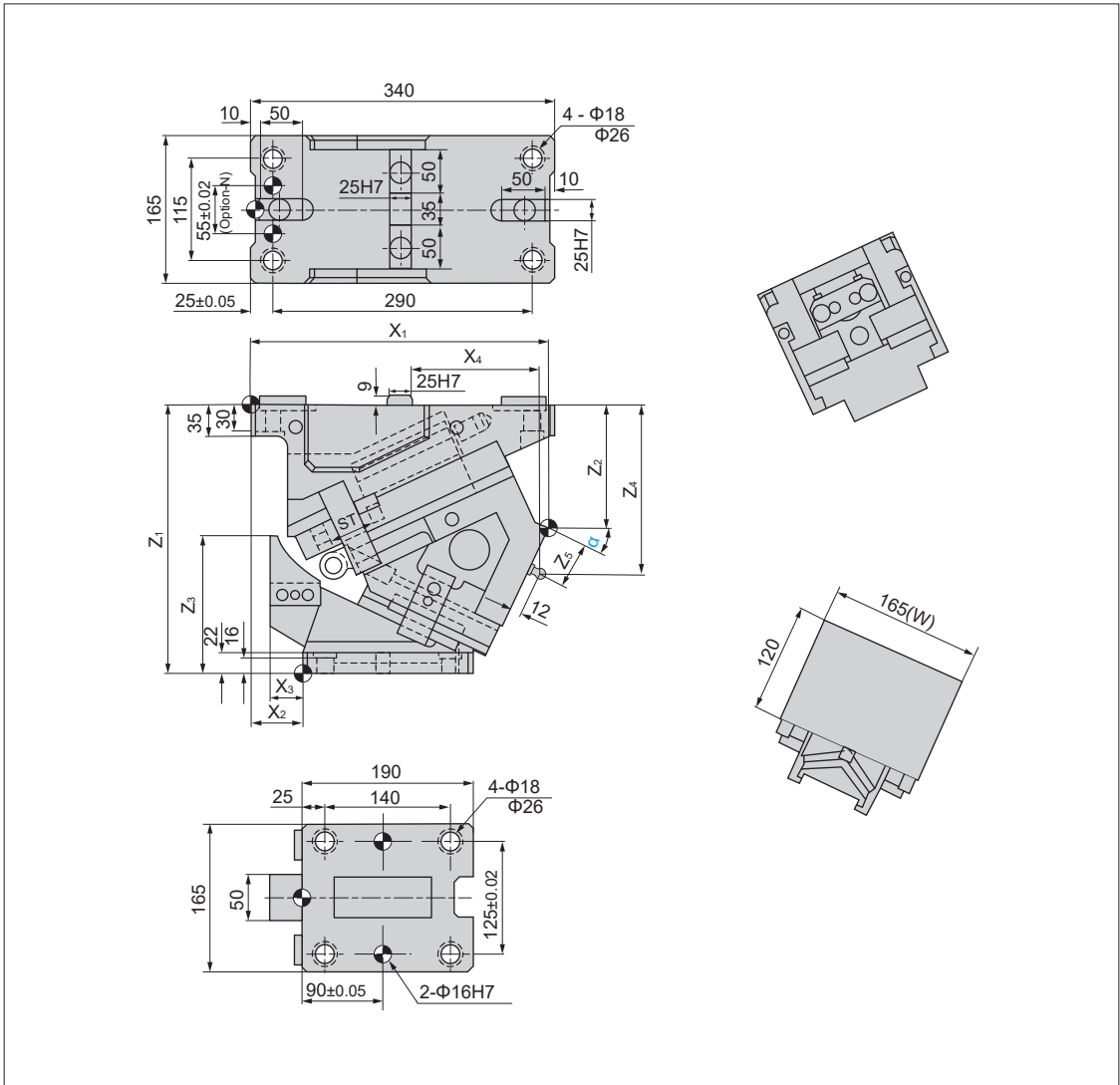
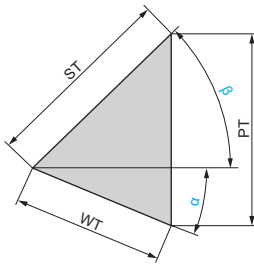

Bestellnr. / Catalog No.	α	β	WT	ST	PT
KACNR165-00	0	50	32.1	50	38.3
KACNR165-05	5	45	35.5		38.4
KACNR165-10	10	40	38.9		38.9
KACNR165-15	15	35	42.4		39.7
KACNR165-20	20	30	46.1		40.8
KACNR165-25	25	25	50.0		42.3

Übersicht Schieberkraft / Rückzugskraft Table of Cam Force

Typ / Type	α	Federkraft (N/kgf) / Spring Force (N / kgf)		Arbeitskraft (kN / tonF) / (KN / tonF) Work Force
		Anfangskraft / Initial Load	Endkraft / Final Load	
Schraubendruckfeder / Coil Spring	00°~60°	449.1 / 45.8	2694.0 / 274.7	294.2 / 30.0
GD DADCO		—	3518.0 / 358.7	
GK KALLER		—	3430.0 / 349.8	

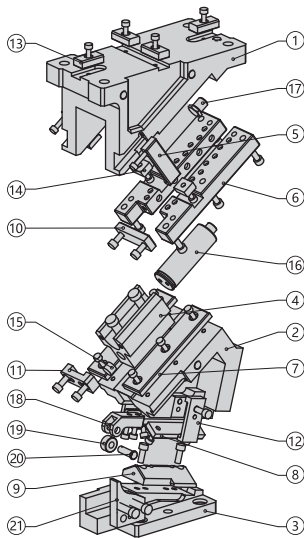

Nr. / No.	Beschreibung / Description	Anzahl / Qty	Material und Anmerkung / Material and Remark
①	Aufnahme / Cam Holder	1	HT300
②	Schieber / Cam Slider	1	HT300
③	Treiber / Cam Driver	1	HT300
④	Federführungsblock / Suspension Arm	1	QT450+Festschmierstoff / graphite plugs
⑤	Sicherungsplatte / Safety Hook	2	St45
⑥	Gleitplatte / Guide Block	1	42CrMo
⑦	Gleitplatte / Guide Block	2	Bronze+Festschmierstoff / graphite plugs
⑧	Gleitplatte / Guide Block	2	Bronze+Festschmierstoff / graphite plugs
⑨	V-Prisma / V Cam Slide Guide	1	42CrMo
⑩	Stoppblock / Stopping Block	1	St45
⑪	Federplatte / Spring Fixed Plate	1	St45
⑫	Zwangsrückführung / Positive Return Follower	2	St45
⑬	Passfeder / Key	4	St45
⑭	Passfeder / Key	2	St45
⑮	Urethan-Dämpfer / Urethane Stopper	1	Urethan
⑯	Gasdruckfeder / Gas Spring	1	Typ / Type
⑰	Distanzstück / Nitrogen Cylinder Top Block	1	St45
⑱	Rollenaufnahme / Roller Stent	1	St45
⑲	Rolle / Roller	1	St45
⑳	Achse / Rotation Axis	1	St45
㉑	Beschleunigerkurve / Accelerator	1	St45

Options-Code / Option Code	Beschreibung / Envelope	Modell / Model
GD	Gasdruckfeder DADCO / Gas Spring by DADCO	L300.063.138
GK	Gasdruckfeder KALLER/Fibro / Gas Spring by KALLER	TU250-63.5
ISO	Schraubendruckfeder (Federrate = 44,9 N/mm) / Coil Spring (Spring rate = 44.9 N/mm)	TJM40-178
N	Φ16H7 Stiftlöcher in Aufnahme gebohrt / Φ16H7 dowel hole is drilled on the cam holder	

Bestellnummer / Order Number

	Bestellnr. / Catalog No.	-	(W)	-	(α)	-	Typ / Type
	KACNR	-	165	-	20	-	GK

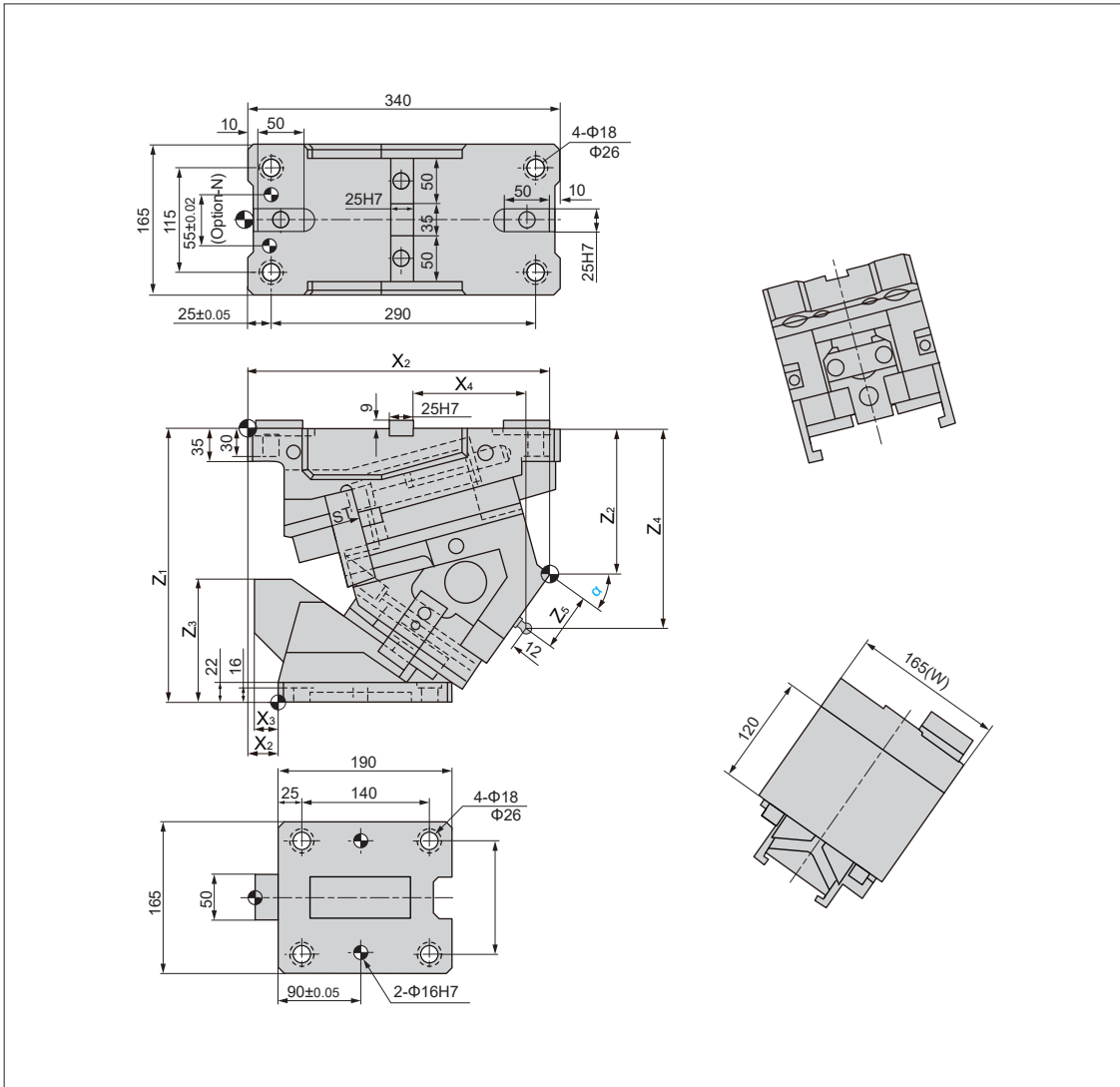

KACNR165

**Tabelle Schieber
Table of Cam Structure**

Bestellnr. / Catalog No.	W	X ₁	X ₂	X ₃	X ₄	Z ₁	Z ₂	Z ₃	Z ₄	Z ₅	Gewicht (kg) / Weight (kg)
KACNR165-30	165	334.28	48	30	132.5	300	148.28	125.0	205	58.57	71.9
KACNR165-35	165	329.80	33	25	125.0	300	158.89	135.0	215	60.10	72.2
KACNR165-40	165	321.35	15	25	117.5	300	170.38	155.0	225	61.23	72.4
KACNR165-45	165	314.86	0	25	111.5	300	182.66	155.0	235	62.03	65.5
KACNR165-50	165	307.27	-15	0	105.5	300	195.63	136.6	245	62.51	64.3
KACNR165-55	165	296.59	-32	0	120.0	300	210.30	140.0	255	60.80	65.2
KACNR165-60	165	288.56	-45	0	113.0	300	222.26	145.5	265	64.69	66.6

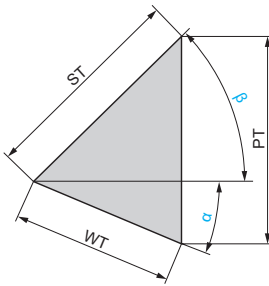



Bestellnr. / Catalog No.	α	β	WT	ST	PT
KACNR165-30	30	20	54.3	50	44.2
KACNR165-35	35	15	59.0		46.8
KACNR165-40	40	10	64.3		50.0
KACNR165-45	45	5	70.4		54.2
KACNR165-50	50	0	77.8		59.6
KACNR165-55	55		87.2		71.4
KACNR165-60	60		100.0	86.6	

**Übersicht Schieberkraft / Rückzugskraft
Table of Cam Force**

Typ / Type	α	Federkraft (N/kgf) / Spring Force (N / kgf)		Arbeitskraft (kN / tonF) / (KN / tonF) Work Force
		Anfangskraft / Initial Load	Endkraft / Final Load	
Schraubendruckfeder / Coil Spring	30° ~ 60°	449.1 / 45.8	2694.0 / 274.7	294.2 / 30.0
GD DADCO		—	3518.0 / 358.7	
GK KALLER		—	3430.0 / 349.8	

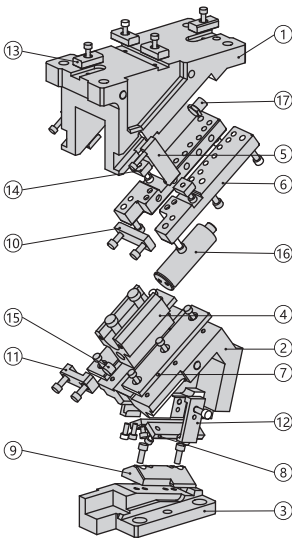

Nr. / No.	Beschreibung / Description	Anzahl / Qty	Material und Anmerkung / Material and Remark
①	Aufnahme / Cam Holder	1	HT300
②	Schieber / Cam Slider	1	HT300
③	Treiber / Cam Driver	1	HT300
④	Federführungsblock / Suspension Arm	1	QT450+Festschmierstoff / graphite plugs
⑤	Sicherungsplatte / Safety Hook	2	St45
⑥	Gleitplatte / Guide Block	1	42CrMo
⑦	Gleitplatte / Guide fblock	2	Bronze+Festschmierstoff / graphite plugs
⑧	Gleitplatte / Guide Block	2	Bronze+Festschmierstoff / graphite plugs
⑨	V-Prisma / V Cam Slide Guide	1	42CrMo
⑩	Stoppblock / Stopping Block	1	St45
⑪	Federplatte / Spring Fixed Plate	1	St45
⑫	Zwangsrückführung / Positive Return Follower	2	St45
⑬	Passfeder / Key	4	St45
⑭	Passfeder / Key	2	St45
⑮	Urethan-Dämpfer / Urethane Stopper	1	Urethan
⑯	Gasdruckfeder / Gas Spring	1	Typ / Type
⑰	Distanzstück / Nitrogen Cylinder Top Block	1	St45

Options-Code / Option Code	Beschreibung / Envelope	Modell / Model
GD	Gasdruckfeder DADCO / Gas Spring by DADCO	L300.063.138
GK	Gasdruckfeder KALLER / Fibro / Gas Spring by KALLER	TU250-63.5
ISO	Schraubendruckfeder (Federrate = 44,9 N/mm) / Coil Spring (Spring rate = 44,9 N/mm)	TJM40-178
N	Φ16H7 Stiftlöcher in Aufnahme gebohrt / Φ16H7 dowel hole is drilled on the cam holder	

Bestellnummer / Order Number

	Bestellnr. / Catalog No.	-	(W)	-	(α)	-	Typ / Type
	KACNR	-	165	-	30	-	GK



KACNR200

Tabelle Schieber
Table of Cam Structure

Bestellnr. / Catalog No.	W	X ₁	X ₂	X ₃	X ₄	Z ₁	Z ₂	Z ₃	Z ₄	Z ₅	Gewicht (kg) / Weight (kg)
KACNR200-00	300	335.84	128	55	180.5	300	96.98	80.0	170	73.02	90.3
KACNR200-05	300	335.25	113	55	173.0	300	100.91	98.0	175	73.32	88.0
KACNR200-10	300	337.27	101	50	165.5	300	111.09	109.0	180	67.86	87.5
KACNR200-15	300	329.78	80	45	156.5	300	122.46	120.0	185	61.53	87.0
KACNR200-20	300	332.68	70	42	149.0	300	129.99	137.0	190	59.49	85.8
KACNR200-25	300	332.88	58	37	140.0	300	138.62	154.0	195	56.61	86.2



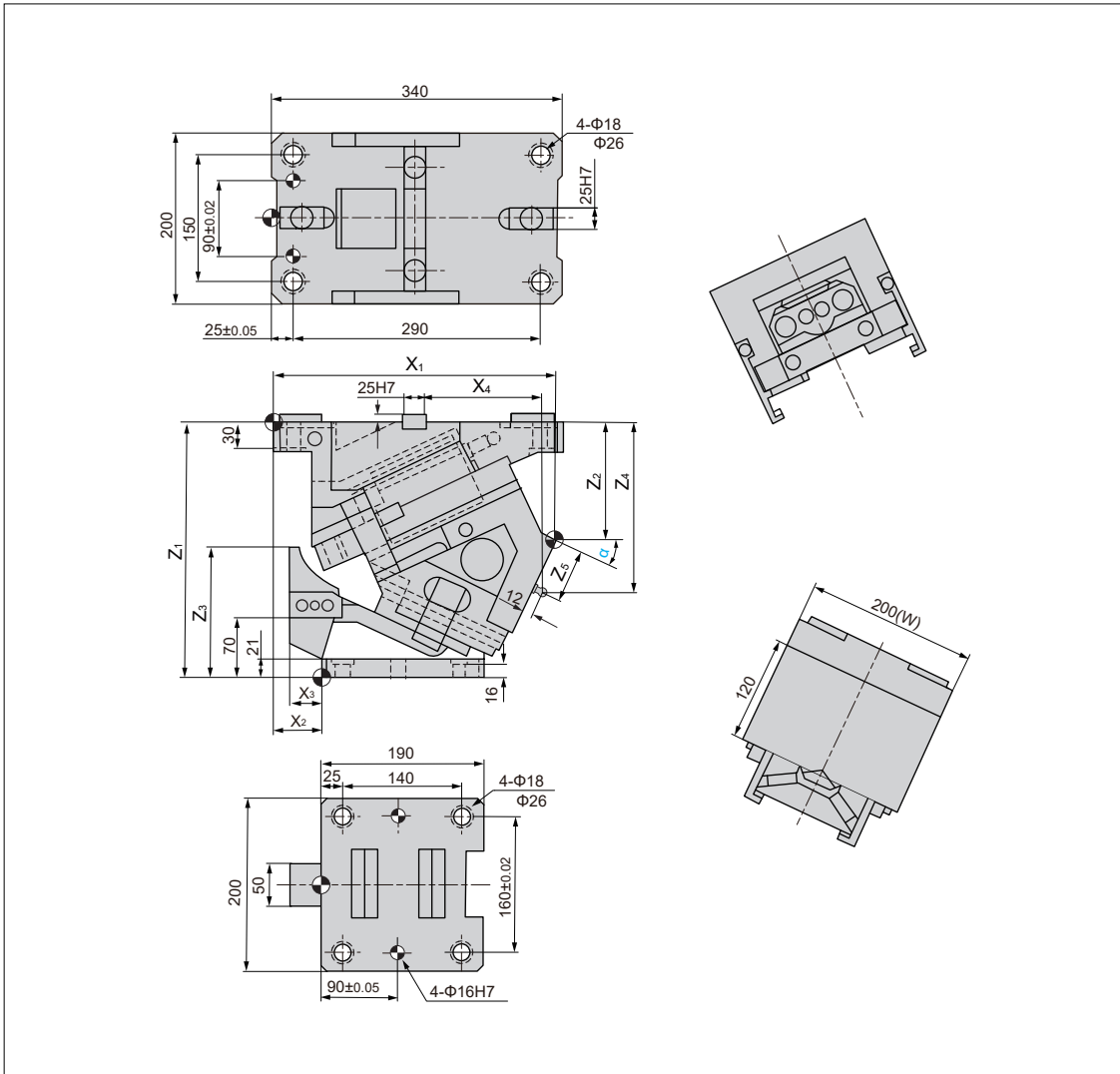
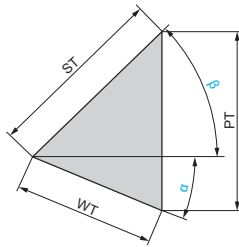

Bestellnr. / Catalog No.	α	β	WT	ST	PT
KACNR200-00	0	50	32.1	50	38.3
KACNR200-05	5	45	35.5		38.4
KACNR200-10	10	40	38.9		38.9
KACNR200-15	15	35	42.4		39.7
KACNR200-20	20	30	46.1		40.8
KACNR200-25	25	25	50.0		42.3

**Übersicht Schieberkraft / Rückzugskraft
Table of Cam Force**

Typ / Type	α	Federkraft (N/kgf) / Spring Force (N / kgf)		Arbeitskraft (kN / tonF) / (KN / tonF) Work Force
		Anfangskraft / Initial Load	Endkraft / Final Load	
Schraubendruckfeder / Coil Spring	00° ~ 25°	749.2 / 76.4	4494.0 / 458.3	353.0 / 36.0
GD DADCO		—	5334.0 / 543.9	
GK KALLER		—	6125.0 / 624.6	

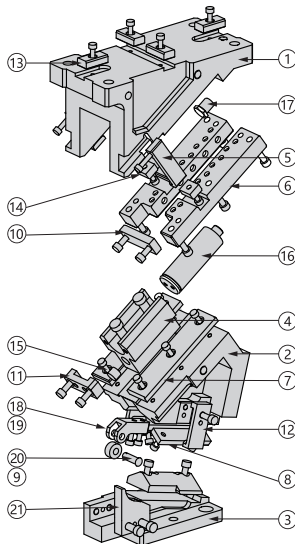

Nr. / No.	Beschreibung / Description	Anzahl / Qty	Material und Anmerkung / Material and Remark
①	Aufnahme / Cam Holder	1	HT300
②	Schieber / Cam Slider	1	HT300
③	Treiber / Cam Driver	1	HT300
④	Federführungsblock / Suspension Arm	1	QT450+Festschmierstoff / graphite plugs
⑤	Sicherungsplatte / Safety Hook	2	St45
⑥	Gleitplatte / Guide Block	3	42CrMo
⑦	Gleitplatte / Guide Block	2	Bronze+Festschmierstoff / graphite plugs
⑧	Gleitplatte / Guide Block	2	Bronze+Festschmierstoff / graphite plugs
⑨	V-Prisma / V Cam Slide Guide	1	42CrMo
⑩	Stoppblock / Stopper	1	St45
⑪	Federblock / Spring Block	1	St45
⑫	Zwangsrückführung / Positive Return Follower	2	St45
⑬	Passfeder / Key	4	St45
⑭	Passfeder / Key	2	St45
⑮	Urethan-Dämpfer / Urethane Stopper	1	Urethan
⑯	Gasdruckfeder / Gas Spring	1	Typ / Type
⑰	Distanzstück / Nitrogen Cylinder Top Block	1	St45
⑱	Rollenaufnahme / Roller Stent	1	St45
⑲	Rolle / Roller	1	St45
⑳	Achse / Rotation Axis	1	St45
㉑	Beschleunigerkurve / Accelerator	1	St45

Options-Code / Option Code	Beschreibung / Envelope	Modell / Model
GD	Gasdruckfeder DADCO / Gas Spring by DADCO	L500.063.138
GK	Gasdruckfeder KALLER / Fibro / Gas Spring by KALLER	TU500-63.5
ISO	Schraubendruckfeder (Federrate = 74,9 N/mm) / Coil Spring (Spring rate = 74.9 N/mm)	TJM50-178
N	Φ16H7 Stiftlöcher in Aufnahme gebohrt / Φ16H7 dowel hole is drilled on the cam holder	

Bestellnummer / Order Number

	Bestellnr. / Catalog No.	-	(W)	-	(α)	-	Typ / Type
	KACNR	-	200	-	20	-	GK

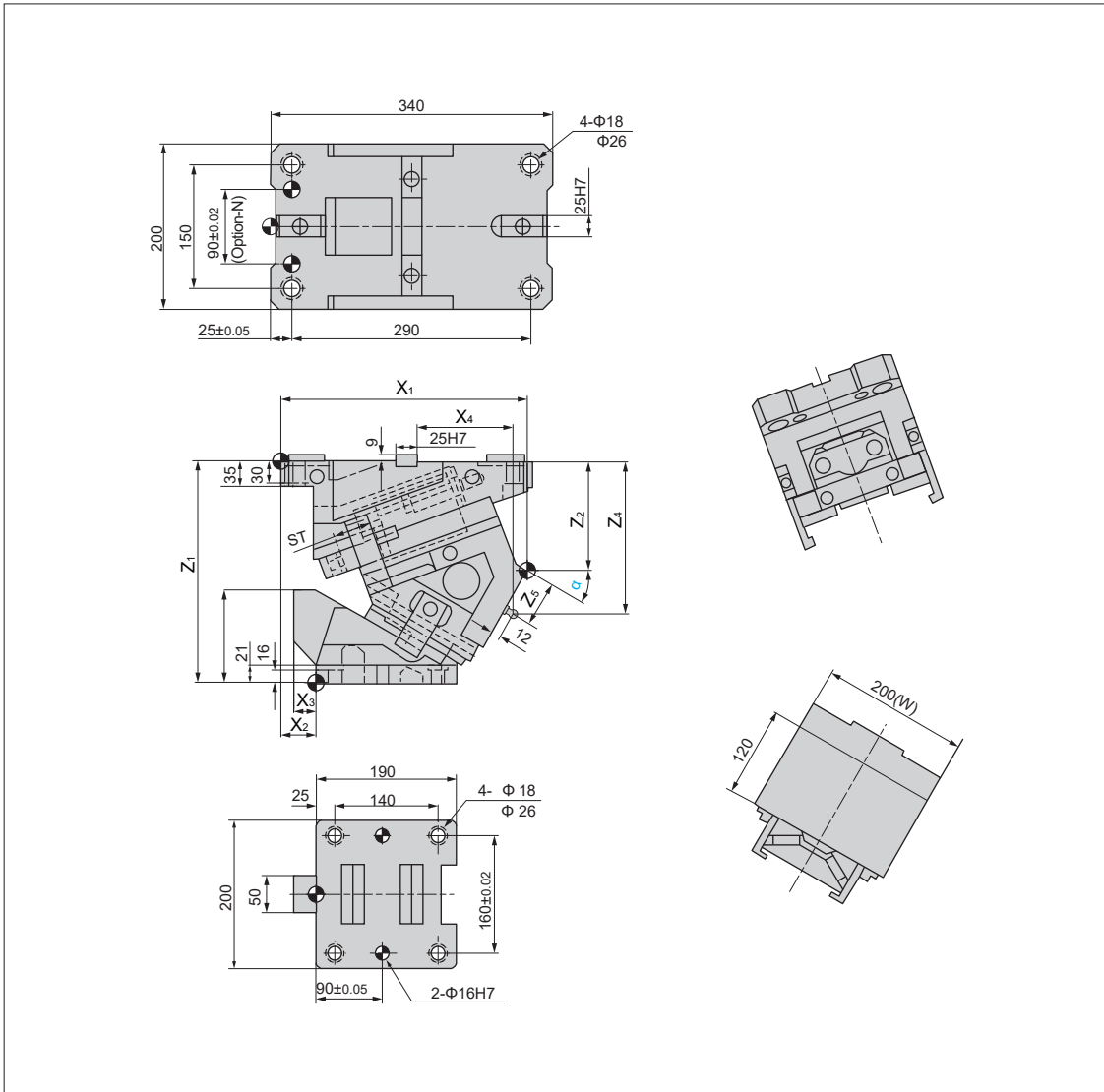

KACNR200

**Tabelle Schieber
Table of Cam Structure**

Bestellnr. / Catalog No.	W	X ₁	X ₂	X ₃	X ₄	Z ₁	Z ₂	Z ₃	Z ₄	Z ₅	Gewicht (kg) / Weight (kg)
KACNR200-30	300	334.28	48	30	132.5	300	148.28	125.0	205	58.57	85.6
KACNR200-35	300	329.80	33	25	125.0	300	158.89	135.0	215	60.10	86.2
KACNR200-40	300	321.35	15	25	117.5	300	170.38	155.0	225	61.23	86.6
KACNR200-45	300	314.86	0	25	111.5	300	182.66	155.0	235	62.02	88.0
KACNR200-50	300	307.27	-15	0	105.5	300	195.63	137.0	245	62.51	78.2
KACNR200-55	300	296.59	-32	0	120.0	300	210.30	140.3	255	60.80	80.5
KACNR200-60	300	288.56	-45	0	113.0	300	222.26	145.7	265	64.69	82.4



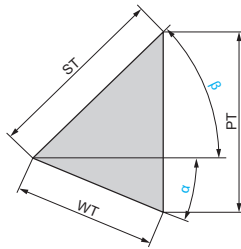

Bestellnr. / Catalog No.	α	β	WT	ST	PT
KACNR200-30	30	20	54.3	50	44.2
KACNR200-35	35	15	59.0		46.8
KACNR200-40	40	10	64.3		50.0
KACNR200-45	45	5	70.4		54.2
KACNR200-50	50	0	77.8		59.6
KACNR200-55	55		87.2		71.4
KACNR200-60	60		100.0		86.6

**Übersicht Schieberkraft / Rückzugskraft
Table of Cam Force**

Typ / Type	α	Federkraft (N/kgf) / Spring Force (N / kgf)		Arbeitskraft (kN / tonF) / (KN / tonF) Work Force
		Anfangskraft / Initial Load	Endkraft / Final Load	
Schraubendruckfeder / Coil Spring	30° ~ 60°	749.2 / 76.4	4494.0 / 458.3	353.0 / 36.0
GD DADCO		—	5334.0 / 543.9	
GK KALLER		—	6125.0 / 624.6	

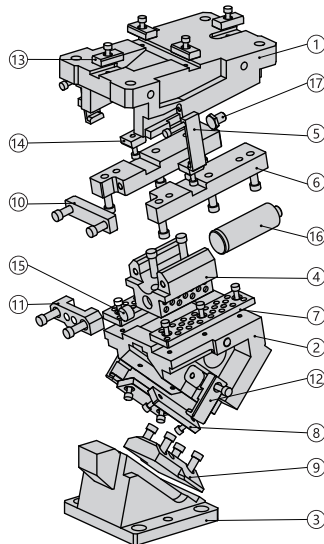

Nr. / No.	Beschreibung / Description	Anzahl / Qty	Material und Anmerkung / Material and Remark
①	Aufnahme / Cam Holder	1	HT300
②	Schieber / Cam Slider	1	HT300
③	Treiber / Cam Driver	1	HT300
④	Federführungsblock / Suspension Arm	1	QT450+Festschmierstoff / graphite plugs
⑤	Sicherungsplatte / Safety Hook	2	St45
⑥	Gleitplatte / Guide Block	3	42CrMo
⑦	Gleitplatte / Guide Block	2	Bronze+Festschmierstoff / graphite plugs
⑧	Gleitplatte / Guide Block	2	Bronze+Festschmierstoff / graphite plugs
⑨	V-Prisma / V Cam Slide Guide	1	42CrMo
⑩	Stoppblock / Stopper	1	St45
⑪	Federblock / Spring Block	1	St45
⑫	Zwangsrückführung / Positive Return Follower	2	St45
⑬	Passfeder / Key	4	St45
⑭	Passfeder / Key	2	St45
⑮	Urethan-Dämpfer / Urethane Stopper	1	Urethan
⑯	Gasdruckfeder / Gas Spring	1	Typ / Type
⑰	Distanzstück / Nitrogen Cylinder Top Block	1	St45

Options-Code / Option Code	Beschreibung / Envelope	Modell / Model
GD	Gasdruckfeder DADCO / Gas Spring by DADCO	L500.063.138
GK	Gasdruckfeder KALLER/Fibro / Gas Spring by KALLER	TU500-63.5
ISO	Schraubendruckfeder (Federrate = 74,9 N/mm) / Coil Spring (Spring rate = 74.9 N/mm)	TJM50-178
N	Φ16H7 Stiftlöcher in Aufnahme gebohrt / Φ16H7 dowel hole is drilled on the cam holder	

Bestellnummer / Order Number

	Bestellnr. / Catalog No.	-	(W)	-	(α)	-	Typ / Type
	KACNR	-	200	-	30	-	GK



KACNR300/400

Tabelle Schieber
Table of Cam Structure

Bestellnr. / Catalog No.	W	X ₁	X ₂	X ₃	X ₄	Z ₁	Z ₂	Z ₃	Z ₄	Z ₅	Gewicht (kg) / Weight (kg)
KACNR300 / 400-00	300 / 400	313.00	138	55	193.0	375	98.00	114.0	180	82.00	153.2 / 160.2
KACNR300 / 400-05	300 / 400	317.15	125	55	182.5	375	104.19	127.0	185	80.07	152.5 / 159.2
KACNR300 / 400-10	300 / 400	324.13	115	55	172.0	375	111.86	139.0	190	77.23	151.4 / 158.4
KACNR300 / 400-15	300 / 400	325.81	100	55	161.5	375	121.01	152.0	195	73.39	154.1 / 161.1
KACNR300 / 400-20	300 / 400	327.08	85	55	151.0	375	131.59	164.0	200	68.43	148.2 / 155.2
KACNR300 / 400-25	300 / 400	334.71	75	50	140.5	375	138.65	182.0	205	67.61	150.2 / 157.3



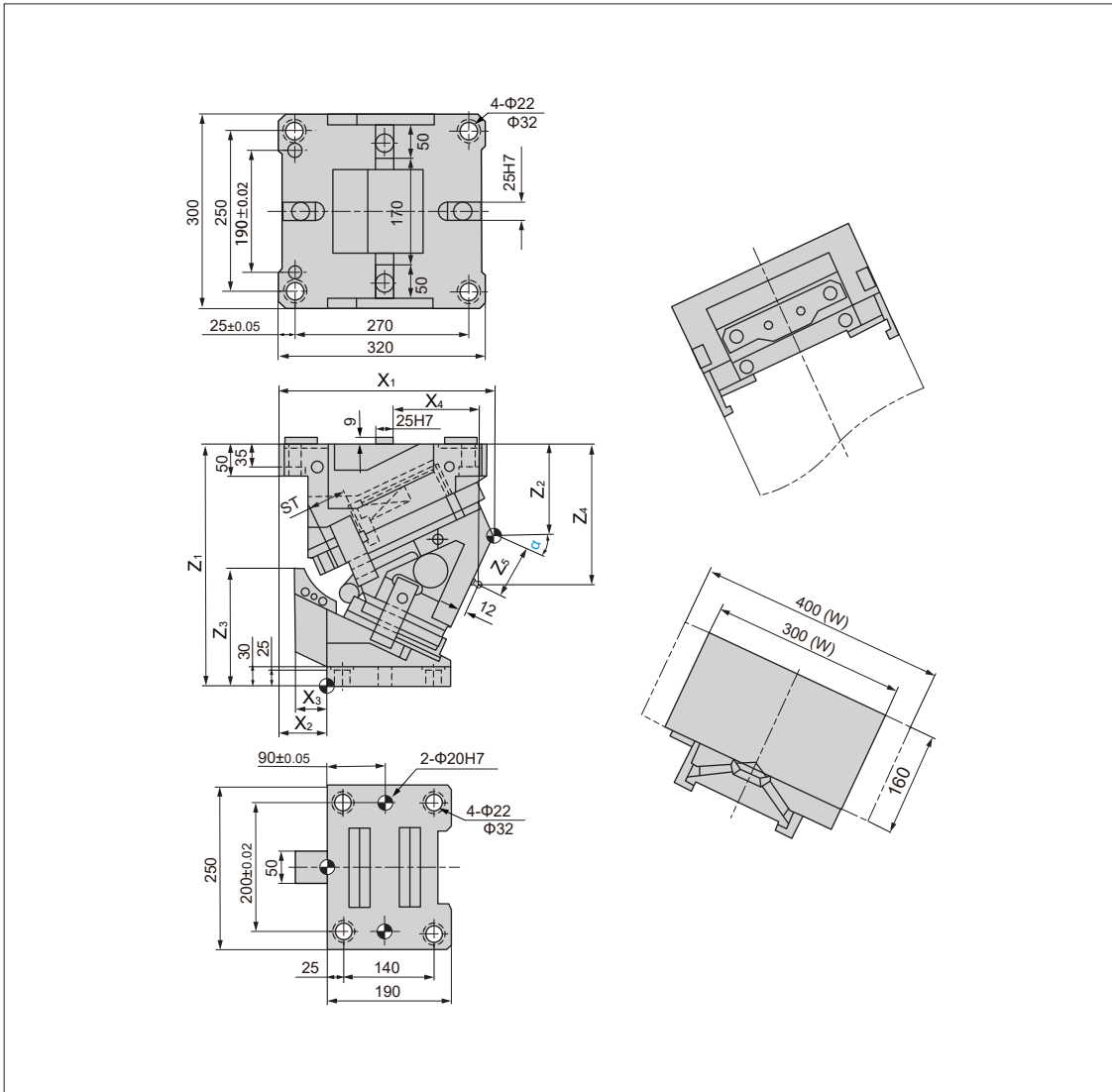
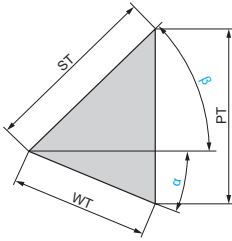

Bestellnr. / Catalog No.	α	β	WT	ST	PT
KACNR300 / 400-00	0	50	38.6	60	46.0
KACNR300 / 400-05	5	45	42.6		46.1
KACNR300 / 400-10	10	40	46.7		46.7
KACNR300 / 400-15	15	35	50.9		47.6
KACNR300 / 400-20	20	30	55.3		48.9
KACNR300 / 400-25	25	25	60.0		50.7

**Übersicht Schieberkraft / Rückzugskraft
Table of Cam Force**

Typ / Type	α	Federkraft (N/kgf) / Spring Force (N / kgf)		Arbeitskraft (kN / tonF) / (KN / tonF) Work Force
		Anfangskraft / Initial Load	Endkraft / Final Load	
Schraubendruckfeder / Coil Spring	00° ~ 25°	1314.1 / 134.0	9198.0 / 937.9	451.1 / 46.0
GD DADCO		—	10668.0 / 1087.8	
GK KALLER		—	10668.0 / 1087.8	

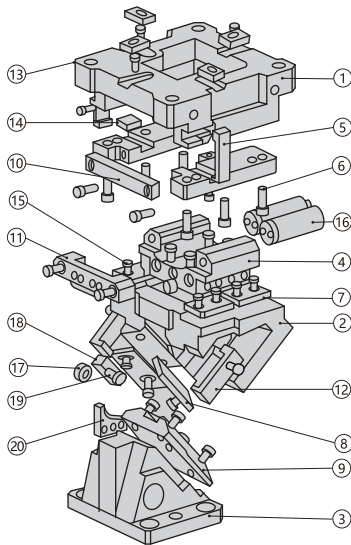

Nr. / No.	Beschreibung / Description	Anzahl / Qty	Material und Anmerkung / Material and Remark
①	Aufnahme / Cam Holder	1	HT300
②	Schieber / Cam Slider	1	HT300
③	Treiber / Cam Driver	1	HT300
④	Federführungsblock / Hanger	1	QT450+Festschmierstoff / graphite plugs
⑤	Sicherungsplatte / Safety Hook	2	St45
⑥	Gleitplatte / Guide Block	2	42CrMo
⑦	Gleitplatte / Guide Block	4	Bronze+Festschmierstoff / graphite plugs
⑧	Gleitplatte / Guide Block	2	Bronze+Festschmierstoff / graphite plugs
⑨	V-Prisma / V Cam Slide Guide	1	42CrMo
⑩	Stoppblock / Stopping Block	1	St45
⑪	Federplatte / Spring Fixed Plate	1	St45
⑫	Zwangsrückführung / Positive Return Follower	2	St45
⑬	Passfeder / Key	4	St45
⑭	Passfeder / Key	2	St45
⑮	Urethan-Dämpfer / Urethane Stopper	3	Urethan
⑯	Gasdruckfeder / Gas Spring	2	Typ / Type
⑰	Rollenaufnahme / Roller Stent	1	St45
⑱	Rolle / Roller	1	St45
⑲	Achse / Rotation Axis	1	St45
⑳	Beschleunigerkurve / Accelerator	1	St45

Options-Code / Option Code	Beschreibung / Envelope	Modell / Model
GD	Gasdruckfeder DADCO / Gas Spring by DADCO	L500.075.138
GK	Gasdruckfeder KALLER / Fibro / Gas Spring by KALLER	K500-80
ISO	Schraubendruckfeder (Federrate = 65,7 N/mm) / Coil Spring (Spring rate = 65.7 N/mm)	TJM50-203
N	Φ16H7 Stiftlöcher in Aufnahme gebohrt / Φ16H7 dowel hole is drilled on the cam holder	

Bestellnummer / Order Number

	Bestellnr. / Catalog No.	-	(W)	-	(α)	-	Typ / Type
	KACNR	-	300	-	20	-	GK
	KACNR	-	400	-	20	-	GK

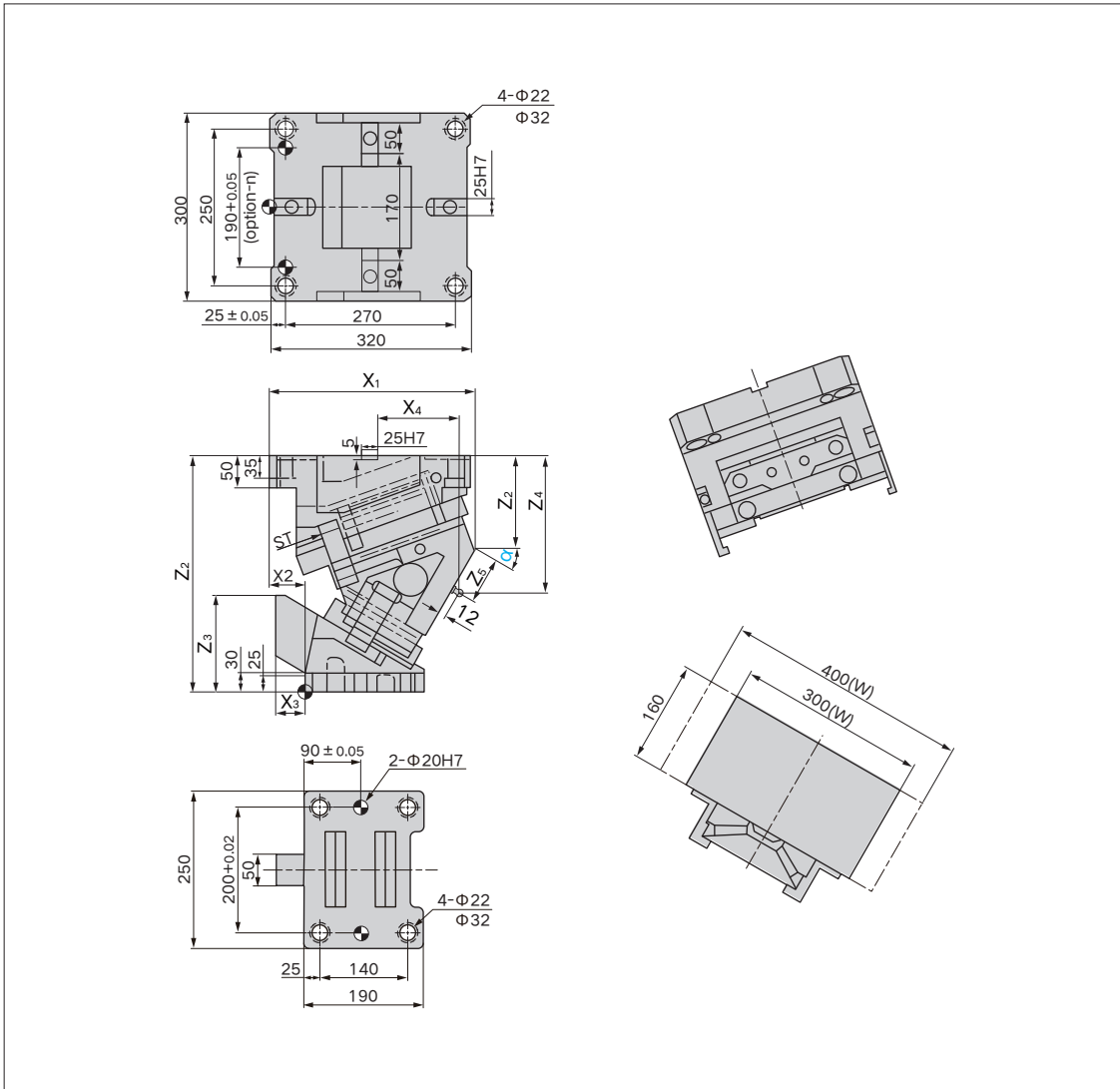

KACNR300 / 400

**Tabelle Schieber
Table of Cam Structure**

Bestellnr. / Catalog No.	W	X ₁	X ₂	X ₃	X ₄	Z ₁	Z ₂	Z ₃	Z ₄	Z ₅	Gewicht (kg) / Weight (kg)
KACNR300 / 400-30	300 / 400	327.83	55	45	130.0	375	146.89	152.0	215	71.72	147.3 / 154.3
KACNR300 / 400-35	300 / 400	334.51	45	35	121.0	375	159.17	159.7	225	71.97	148.0 / 155.0
KACNR300 / 400-40	300 / 400	325.46	25	30	112.0	375	167.30	167.7	235	78.30	146.2 / 153.3
KACNR300 / 400-45	300 / 400	324.83	7	30	103.0	375	179.23	178.3	245	81.01	148.6 / 155.6
KACNR300 / 400-50	300 / 400	306.63	-35	0	94.0	375	196.84	193.1	265	91.73	122.5 / 127.7
KACNR300 / 400-55	300 / 400	277.93	-85	0	86.5	375	229.29	190.7	285	79.99	130.9 / 135.9
KACNR300 / 400-60	300 / 400	286.45	-85	0	79.0	375	245.64	196.0	300	87.94	135.3 / 140.4

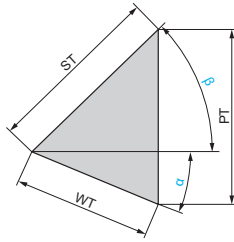



Bestellnr. / Catalog No.	α	β	WT	ST	PT
KACNR300 / 400-30	30	20	65.1	60	53.1
KACNR300 / 400-35	35	15	70.8		56.1
KACNR300 / 400-40	40	10	77.1		60.0
KACNR300 / 400-45	45	5	84.5	51	65.0
KACNR300 / 400-50	50	0	79.3		60.8
KACNR300 / 400-55	55		88.9		72.8
KACNR300 / 400-60	60		102.0		88.3

**Übersicht Schieberkraft / Rückzugskraft
Table of Cam Force**

Typ / Type	α	Federkraft (N/kgf) / Spring Force (N / kgf)		Arbeitskraft (kN / tonF) / (KN / tonF) Work Force
		Anfangskraft / Initial Load	Endkraft / Final Load	
Schraubendruckfeder / Coil Spring	30° ~ 60°	1314.1 / 134.0	9198.0 / 937.9	451.1 / 46.0
GD DADCO		—	10668.0 / 1087.8	
GK KALLER		—	10668.0 / 1087.8	

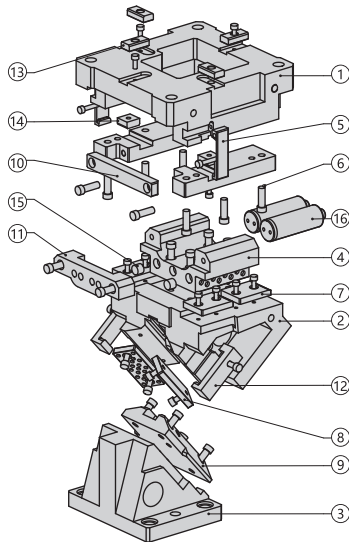

Nr. / No.	Beschreibung / Description	Anzahl / Qty	Material und Anmerkung / Material and Remark
①	Aufnahme / Cam Holder	1	HT300
②	Schieber / Cam Slider	1	HT300
③	Treiber / Cam Driver	1	HT300
④	Federführungsblock / Hanger	1	QT450+Festschmierstoff / graphite plugs
⑤	Sicherungsplatte / Safety Hook	2	St45
⑥	Gleitplatte / Guide Block	2	42CrMo
⑦	Gleitplatte / Guide Block	4	Bronze+Festschmierstoff / graphite plugs
⑧	Gleitplatte / Guide Block	2	Bronze+Festschmierstoff / graphite plugs
⑨	V-Prisma / V Cam Slide Guide	1	42CrMo
⑩	Stopblock / Stopping Block	1	St45
⑪	Federplatte / Spring Fixed Plate	1	St45
⑫	Zwangsrückführung / Positive Return Follower	2	St45
⑬	Passfeder / Key	4	St45
⑭	Passfeder / Key	2	St45
⑮	Urethan-Dämpfer / Urethane Stopper	3	Urethan
⑯	Gasdruckfeder / Gas Spring	2	Typ / Type

Options-Code / Option Code	Beschreibung / Envelope	Modell / Model
GD	Gasdruckfeder DADCO / Gas Spring by DADCO	L500.075.138
GK	Gasdruckfeder KALLER / Fibro / Gas Spring by KALLER	K500-80
ISO	Schraubendruckfeder (Federrate = 65,7 N/mm) / Coil Spring (Spring rate = 65.7 N/mm)	TJM50-203
N	Φ16H7 Stiftlöcher in Aufnahme gebohrt / Φ16H7 dowel hole is drilled on the cam holder	

Bestellnummer / Order Number

	Bestellnr. / Catalog No.	-	(W)	-	(α)	-	Typ / Type
	KACNR	-	300	-	30	-	GK
	KACNR	-	400	-	30	-	GK

