



KEAK65



Tabelle Schieber
Table of Cam Structure

Bestellnr. / Catalog No.	W	X ₁	X ₂	Z ₁	Z ₂	Z ₃	Z ₄	Z ₅	Z ₆	Z ₇	Gewicht (kg) / Weight (kg)
KEAK65-00	65	185.94	75	210	56.57	73.40	55	30	80	38.9	19.5
KEAK65-05	65	193.01	70	210	56.57	73.90	55	30	90	42.6	19.8
KEAK65-10	65	196.80	70	210	67.58	83.50	40	30	80	38.9	19.3
KEAK65-15	65	203.77	67	210	68.81	84.70	40	30	90	42.6	19.6
KEAK65-20	65	198.10	60	210	74.31	100.8	10	30	80	38.9	18.1
KEAK65-25	65	204.75	55	210	76.73	103.8	10	30	90	42.6	18.4
KEAK65-30	65	193.63	50	210	89.52	111.0	10	30	80	38.9	17.7
KEAK65-35	65	199.76	45	210	93.06	105.0	10	30	90	42.6	18.0
KEAK65-40	65	188.72	40	210	99.62	120.0	15	25	80	38.9	16.9
KEAK65-45	65	194.13	34	210	104.16	115.0	15	30	90	42.6	17.1
KEAK65-50	65	190.00	30	210	110.00	130.0	10	18	90	42.6	16.8
KEAK65-55	65	190.00	20	210	115.00	130.0	10	18	100	43.2	17.8
KEAK65-60	65	190.00	20	210	115.00	130.0	10	18	100	46.6	17.3
KEAK65-65	65	190.00	0	210	130.00	130.0	10	18	110	43.3	18.5
KEAK65-70	65	190.00	0	210	130.00	130.0	10	18	110	47.2	18.4



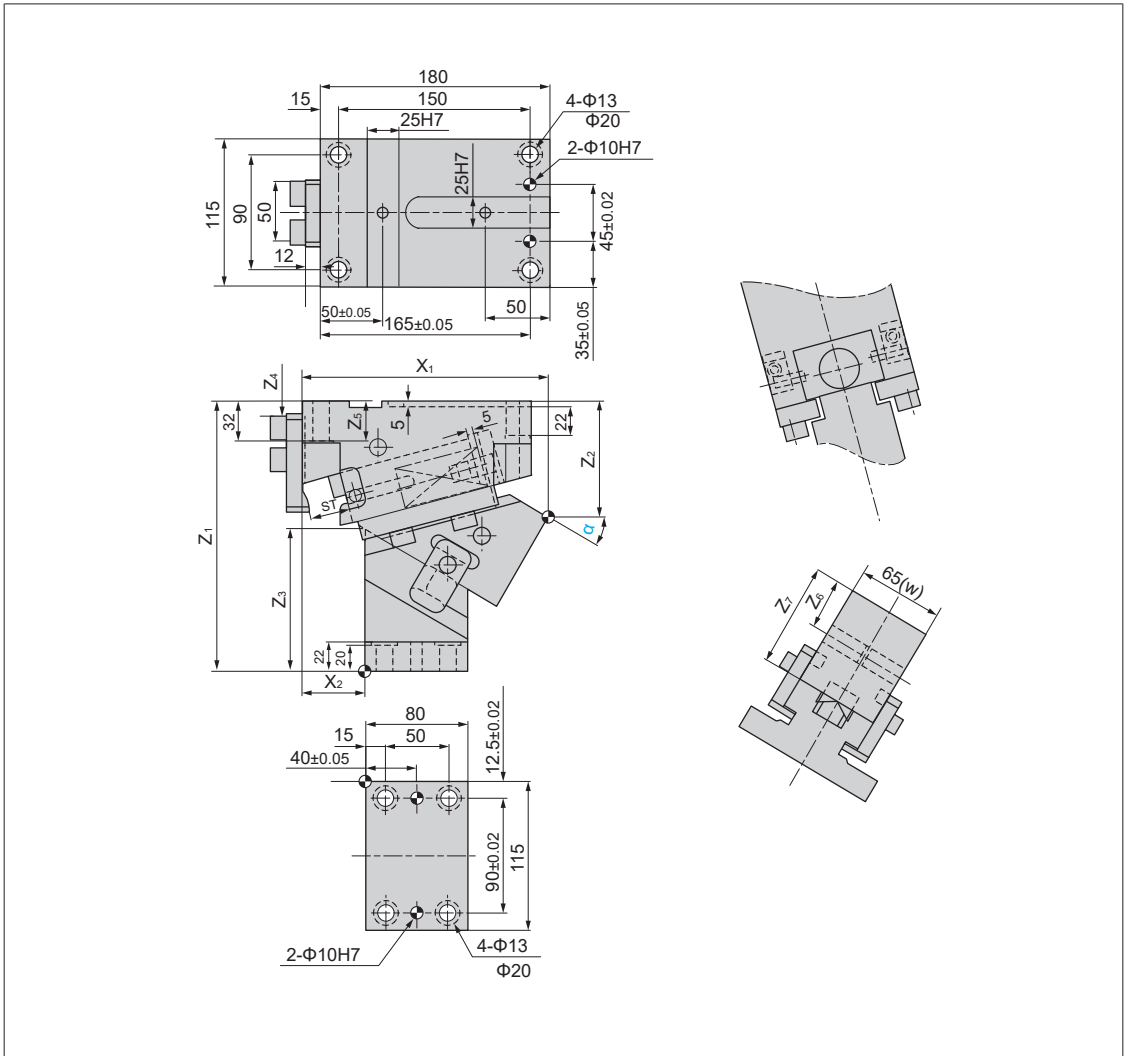
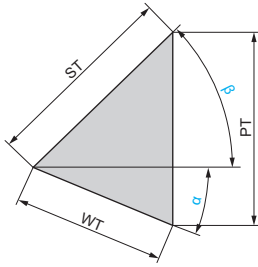

Bestellnr. / Catalog No.	α	β	WT	ST	PT
KEAK65-00	0	45	26.9	38	26.9
KEAK65-05	5	45	27		29.2
KEAK65-10	10	35	31.6		27.3
KEAK65-15	15	35	32.2	35	30.1
KEAK65-20	20	25	33.8		26.3
KEAK65-25	25		35	29.6	
KEAK65-30	30	15	33.5	30	24.5
KEAK65-35	35		35.4		28.1
KEAK65-40	40	5	42.9	33	30.5
KEAK65-45	45		46.5		35.8
KEAK65-50	50	0	54.5	35	41.7
KEAK65-55	55		43.6	25	35.7
KEAK65-60	60		50		43.3
KEAK65-65	65	20	47.3	20	42.9
KEAK65-70	70		58.5		54.9

**Übersicht Schieberkraft / Rückzugskraft
Table of Cam Force**

Typ / Type	α	Modell / Model	Federkraft (N/kgf) / Spring Force (N / kgf)		Arbeitskraft (kN / tonF) / (kN / tonF) Work Force	
			Anfangskraft / Initial Load	Endkraft / Final Load	1 Mio. Hübe / strokes Standard-Arbeitskraft / Standard Working Force	300.000 Hübe / strokes Zulässige Arbeitskraft / Allowable Working Force
Schraubendruckfeder / Coil Spring	00°	TL30 125	165.9 / 16.9	1066.5 / 108.9	19.6 / 2.0	39.2 / 4.0
	05° ~ 15°		237.0 / 24.2			
	20° ~ 25°		308.1 / 31.4			
	30° ~ 35°		426.6 / 43.5			
	40° ~ 45°		355.5 / 36.3			
	50°	308.1 / 31.4				
	55° -- 60°	TL30-100	297.0 / 30.3	1039.5 / 106.1		
65° -- 0°	891.0 / 90.9					

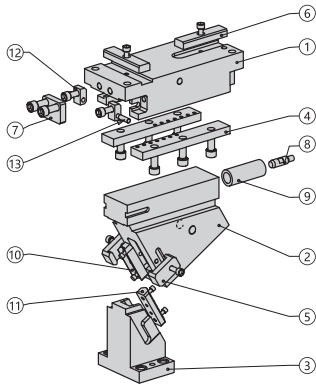

Nr. / No.	Beschreibung / Description	Anzahl / Qty	Material und Anmerkung / Material and Remark
①	Aufnahme / Cam Holder	1	HT300
②	Schieber / Cam Slider	1	HT300+Festschmierstoff / graphite plugs
③	Treiber / Cam Driver	1	HT300
④	Gleitplatte / Upper Plate	2	20Cr+Festschmierstoff / graphite plugs
⑤	Zwangsrückführung / Position Return Follower	2	St45
⑥	Passfeder / Key	2	St45
⑦	Prallplatte / Baffle	1	St45
⑧	Federführungsbolzen / Spring Guide Pin	1	St45
⑨	Feder / Spring	1	Typ / Type
⑩	Gleitstück / U Cam Slide Guide	1	Bronze+Festschmierstoff / graphite plugs
⑪	V-Prisma / V Cam Slide Guide	1	20Cr+Festschmierstoff / graphite plugs
⑫	Sicherungsplatte / Safety Hook	2	St45
⑬	Stift / Pin	2	6x20

Options-Code / Option Code	Beschreibung / Envelope
K	Passfeder in Aufnahme montiert / A key for holder is attached.

Bestellnummer / Order Number

☎	Bestellnr. / Catalog No.	-	(W)	-	(α)
	KEAK	65	-	30	- K
	KEAK	65	-	30	- K

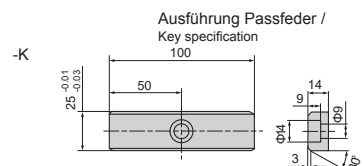

KEAK100

Tabelle Schieber
Table of Cam Structure

Bestellnr. / Catalog No.	W	X_1	X_2	X_3	X_4	X_5	Z_1	Z_2	Z_3	Z_4	Z_5	Z_6	Z_7	Gewicht (kg) / Weight (kg)
KEAK100-00	100	240.00	80	17	110	140	280	85.00	90.00	220	55	38	100	47.0
KEAK100-10	100	240.00	60	17	110	140	280	90.00	100.0	190	35	38	100	47.8
KEAK100-20	100	240.00	50	18	110	140	280	110.0	109.5	165	15	38	100	44.8
KEAK100-30	100	240.00	30	17	100	130	280	110.0	120.0	125	10	38	120	44.1
KEAK100-40	100	240.00	30	17	90	120	280	115.0	145.3	95	10	38	120	40.8
KEAK100-50	100	240.00	10	16	90	120	280	120.0	153.6	80	0	25	140	41.2
KEAK100-60	100	240.00	0	16	80	110	280	145.0	168.1	80	0	25	140	42.5
KEAK100-70	100	240.00	0	16	80	110	280	145.0	179.3	80	0	25	140	41.8



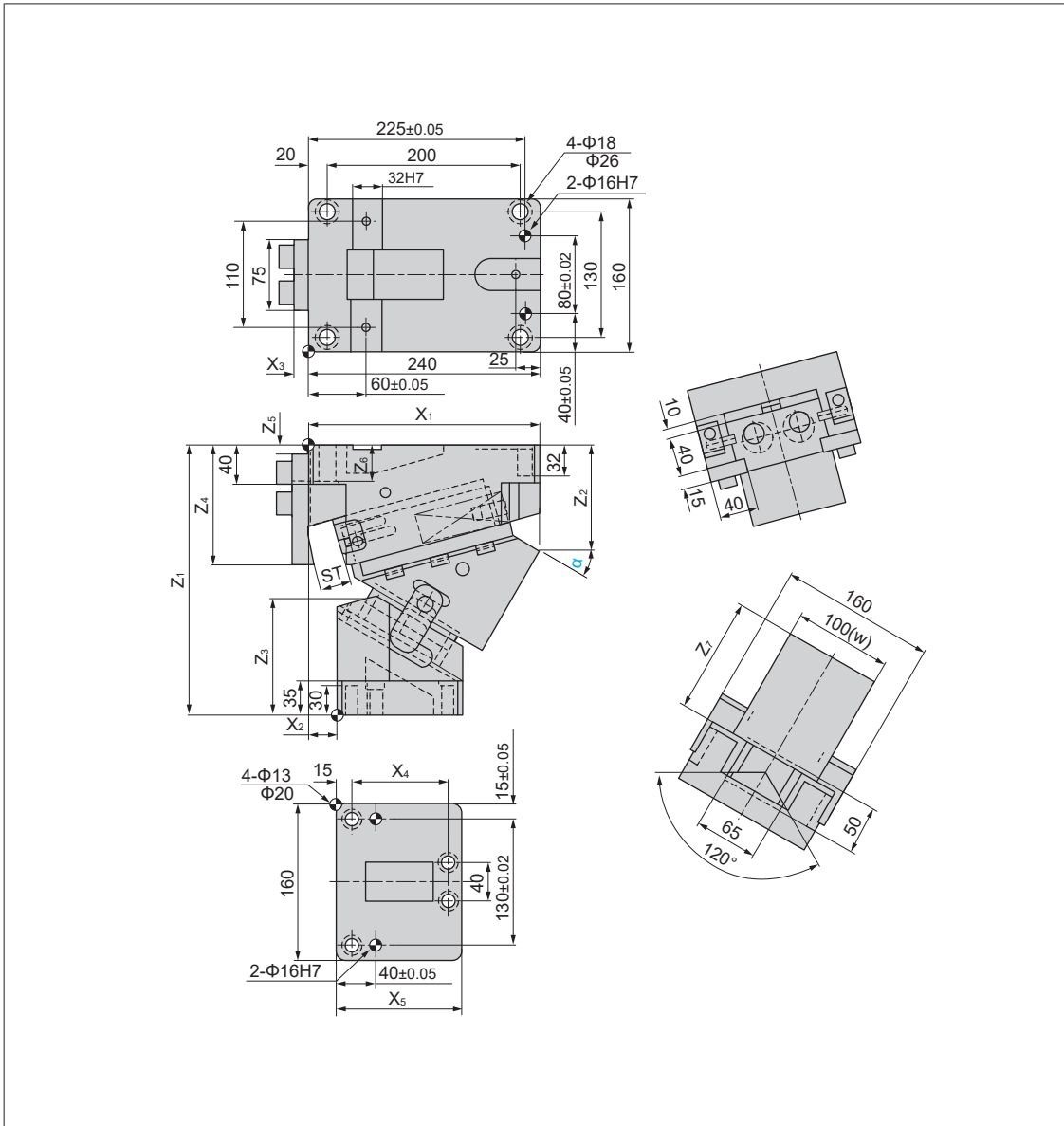
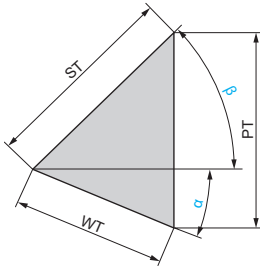

Bestellnr. / Catalog No.	α	β	WT	ST	PT
KEAK100-00	0	45	28.3	40	28.3
KEAK100-10	10	35	33.3		28.7
KEAK100-20	20	25	30.9	32	24.1
KEAK100-30	30	15	33.5	30	24.5
KEAK100-40	40	5	39.0		27.7
KEAK100-50	50		46.7		35.8
KEAK100-60	60	0	60.0		52.0
KEAK100-70	70		58.5	20	54.9

Übersicht Schieberkraft / Rückzugskraft Table of Cam Force

Typ / Type	α	Modell / Model	Federkraft (N/kgf) / Spring Force (N / kgf)		Arbeitskraft (kN / tonF) (KN / tonF) Work Force	
			Anfangskraft / Initial Load	Endkraft / Final Load	1 Mio. Hübe / strokes Standard-Arbeitskraft / Standard Working Force	300.000 Hübe / strokes Zulässige Arbeitskraft / Allowable Working Force
Schraubendruckfeder / Coil Spring	00° ~ 10°	TM30-175	313.0 / 31.9	2817.0 / 287.4	44.1 / 4.5	88.2 / 9.0
	20°	TM30-150	219.6 / 22.4	2562.0 / 261.4		
	30° ~ 60°	TM30-125	175.6 / 17.9	2809.6 / 286.7		
	70°	TM30-100	548.0 / 55.9	2740.0 / 279.6		

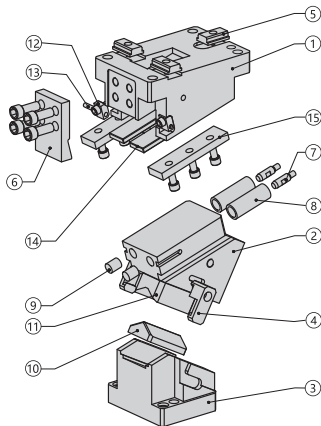

Nr. / No.	Beschreibung / Description	Anzahl / Qty	Material und Anmerkung Material and Remark
①	Aufnahme / Cam Holder	1	HT300
②	Schieber / Cam Slider	1	HT300+Festschmierstoff / graphite plugs
③	Treiber / Cam Driver	2	HT300
④	Zwangsrückführung / Position Return Follower	2	St45
⑤	Passfeder / Key	3	St45
⑥	Prallplatte / Baffle	1	St45
⑦	Federführungsbolzen / Spring Guide Pin	2	St45
⑧	Feder / Spring	2	Typ / Type
⑨	Urethan-Dämpfer / Urethane Stopper	2	Urethan
⑩	V-Prisma / V Cam Slide Guide	1	42CrMo
⑪	Gleitstück / U Cam Slide Guide	1	Bronze+Festschmierstoff / graphite plugs
⑫	Sicherungsplatte / Safety Hook	2	St45
⑬	Stift / Pin	2	8X30
⑭	Gleitplatte / Guide Block	2	Bronze+Festschmierstoff / graphite plugs
⑮	Gleitplatte / Upper plate	2	42CrMo+Festschmierstoff / graphite plugs

Options-Code / Option Code	Beschreibung / Envelope
K	Passfeder in Aufnahme montiert / A key for holder is attached
KA	Metrische Passfeder in Aufnahme montiert / Metric dedicated key is attached for cam holder

Ausführung Passfeder
(bei Option K und KA) /
Key specification

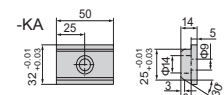
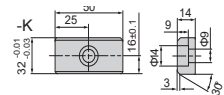

Bestellnummer / Order Number

 Bestellnr. / Catalog No. - (W) - (α)
KEAK - 100 - 30
KEAK - 100 - 30 - K



KEAK200

Tabelle Schieber
Table of Cam Structure

Bestellnr. / Catalog No.	W	X ₁	X ₂	X ₃	Z ₁	Z ₂	Z ₃	Z ₄	Z ₅	Z ₆	Z ₇	Z ₈	Gewicht (kg) / Weight (kg)
KEAK200-00	200	240.00	80	17	280	85.00	90.00	220	55	38	100	190	81.5
KEAK200-10	200	240.00	60	17	280	90.00	113.8	190	35	38	100	150	75.7
KEAK200-20	200	240.00	50	18	280	110.0	118.2	165	15	38	100	150	76.1
KEAK200-30	200	240.00	30	17	280	110.0	125.4	125	10	38	120	150	77.0
KEAK200-40	200	240.00	30	17	280	115.0	139.8	95	10	38	120	150	71.4
KEAK200-50	200	240.00	10	16	280	120.0	149.7	80	0	30	140	150	71.6
KEAK200-60	200	240.00	0	16	280	145.0	155.1	80	0	30	140	150	73.9
KEAK200-70	200	240.00	0	16	280	145.0	179.3	80	0	30	140	150	72.2



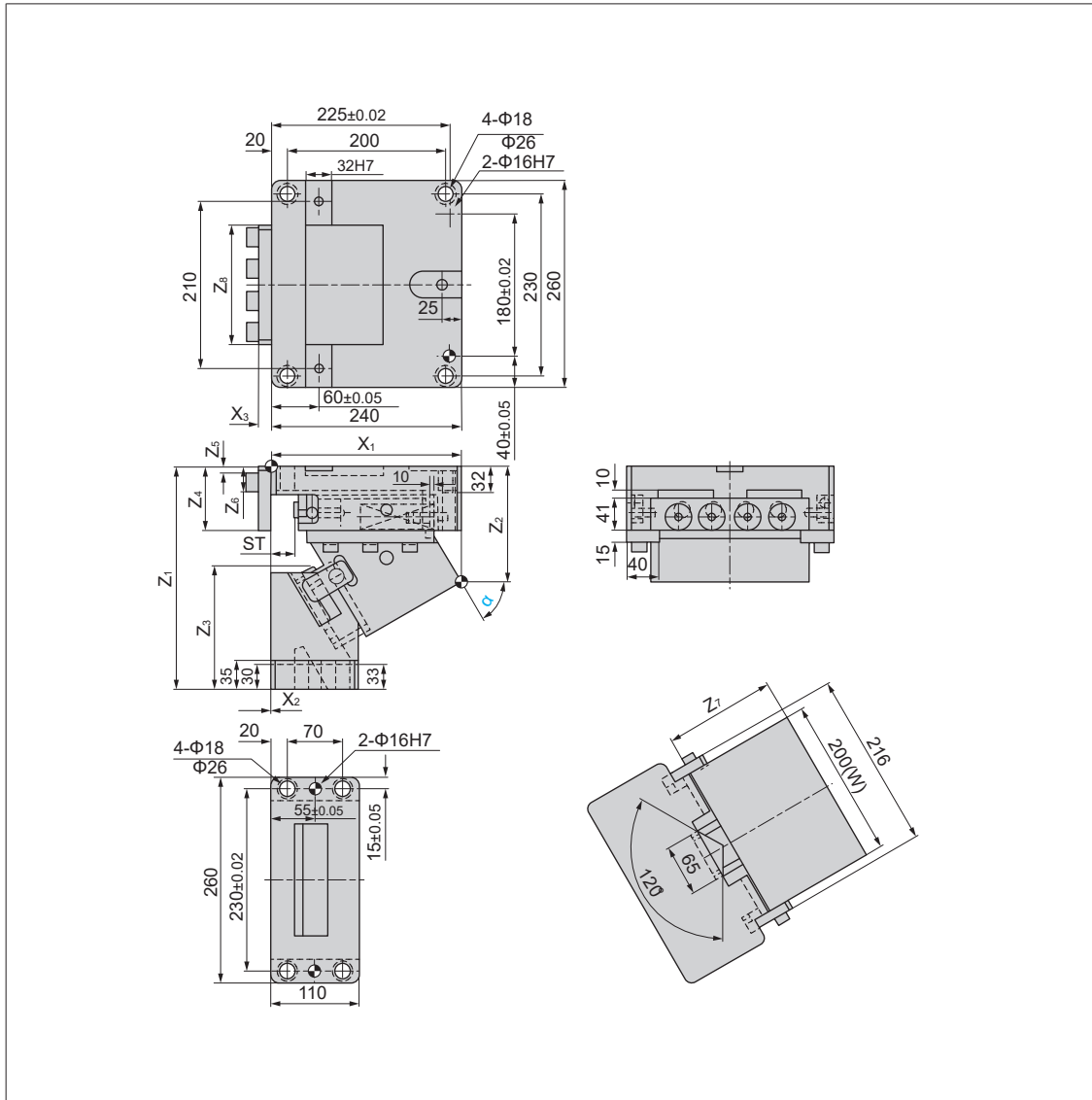
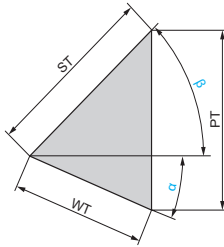

Bestellnr. / Catalog No.	α	β	WT	ST	PT
KEAK200-00	0	45	28.3	40	28.3
KEAK200-10	10	35	33.3		28.7
KEAK200-20	20	25	30.9	30	24.1
KEAK200-30	30	15	33.5		24.5
KEAK200-40	40	5	39.0		27.7
KEAK200-50	50	0	46.7		35.8
KEAK200-60	60		60.0		52.0
KEAK200-70	70		58.5	20	54.9

**Übersicht Schieberkraft / Rückzugkraft
Table of Cam Force**

Typ / Type	α	Modell / Model	Federkraft (N/kgf) / Spring Force (N / kgf)		Arbeitskraft (kN / tonF) / (kN / tonF) Work Force	
			Anfangskraft / Initial Load	Endkraft / Final Load	1 Mio. Hübe / strokes Standard-Arbeitskraft / Standard Working Force	300.000 Hübe / strokes Zulässige Arbeitskraft / Allowable Working Force
GK KALLER	00° ~ 10°	TM30-175	626.0 / 44.8	5634.0 / 574.9	93.1 / 9.5	186.2 / 63.9
	20°	TM30-150	439.2 / 44.8	5124.0 / 522.9		
	30° ~ 60°	TM30-125	351.2 / 35.8	5619.2 / 573.4		
	70°	TM30-100	1096.0 / 111.8	5480.0 / 559.2		

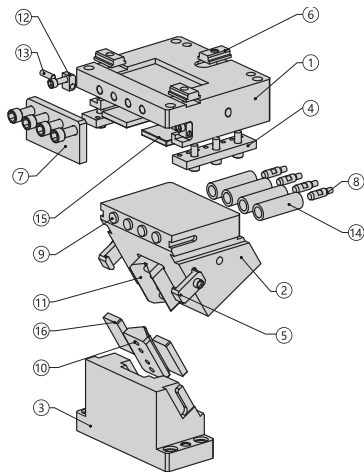

Nr. / No.	Beschreibung / Description	Anzahl / Qty	Material und Anmerkung / Material and Remark
①	Aufnahme / Cam Holder	1	HT300
②	Schieber / Cam Slider	1	HT300+Festschmierstoff / graphite plugs
③	Treiber / Cam Driver	1	HT300
④	Gleitplatte / Upper Plate	2	42CrMo
⑤	Zwangsrückführung / Position Return Follower	2	St45
⑥	Passfeder / Key	3	St45
⑦	Prallplatte / Baffle	1	St45
⑧	Federführungsbolzen / Spring Guide Pin	4	St45
⑨	Urethan-Dämpfer / Urethane Stopper	4	Urethan
⑩	V-Prisma / V Cam Slide Guide	1	42CrMo
⑪	Gleitstück / U Cam Slide Guide	1	Bronze+Festschmierstoff / graphite plugs
⑫	Sicherungsplatte / Safety Hook	2	St45
⑬	Stift / Pin	4	10X32
⑭	Feder / Spring	4	Typ / Type
⑮	Gleitplatte / Guide Block	2	Bronze+Festschmierstoff / graphite plugs
⑯	Gleitplatte / Guide Block	2	Bronze+Festschmierstoff / graphite plugs

Options-Code / Option Code	Beschreibung / Envelope
K	Passfeder in Aufnahme montiert / A key for holder is attached
KA	Metrische Passfeder in Aufnahme montiert / Metric dedicated key is attached to cam holder

Bestellnummer / Order Number

	Bestellnr. / Catalog No.	-	(W)	-	(α)
	KEAK	-	200	-	30
	KEAK	-	200	-	30 - K

**Ausführung Passfeder /
Key specification**
